

Australia's Great Train Holidays

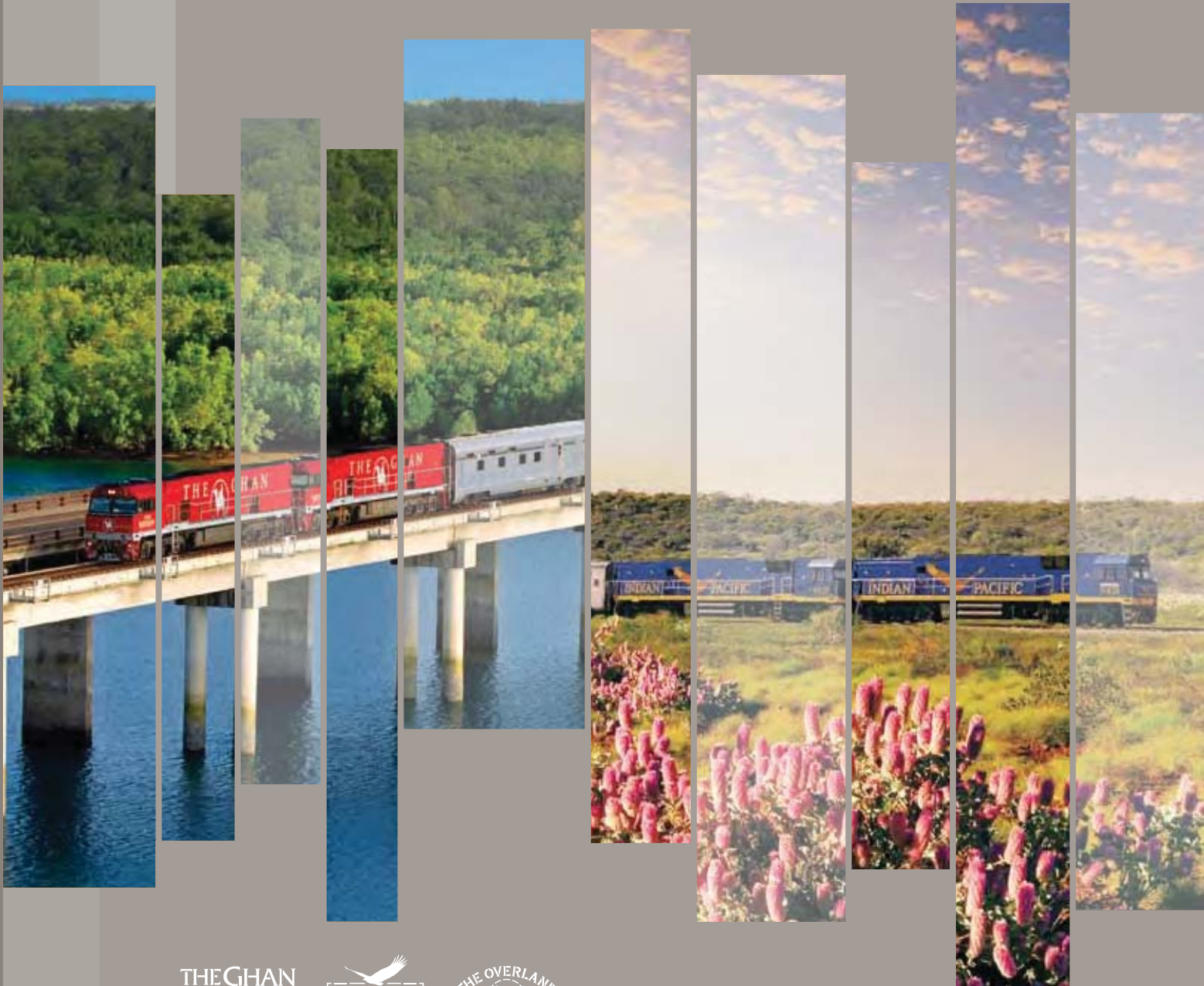

01 April 2014 - 31 March 2015

Australia's Great Train Holidays

The Ghan

- The Ghan's symbol is a camel and its handler in recognition of the pioneering Afghan cameleers and their journeys through the heart of the Red Centre.
- The Journey – Adelaide to Darwin or Darwin to Adelaide – two nights and three days via Alice Springs and Katherine one way.
- Length of Journey – Adelaide to Darwin, 2,979km.
- Shorter journeys are available including Adelaide to Alice Springs and vice versa or Alice Springs to Darwin and vice versa.

Indian Pacific

- The Indian Pacific's symbol is the wedge-tail eagle, Australia's largest eagle. Its massive two metre wingspan symbolises the epic journey of the Indian Pacific.
- The Journey – Sydney to Perth or Perth to Sydney – three nights and three days via Broken Hill, Adelaide and Kalgoorlie one way.
- Length of Journey – Sydney to Perth, 4,352km.
- Shorter journeys are available including Adelaide to Perth and vice versa or Adelaide to Sydney and vice versa.

The Overland

- The Overland's symbol is an emu. This truly Australian bird is recognised for its speed and grace as it runs through the wide open lands.
- The Journey – Adelaide to Melbourne or Melbourne to Adelaide stopping en route – 10.5 hours.
- Length of Journey – Melbourne to Adelaide, 828km.

Off Train Excursions

There's nothing quite like the magic and romance of a relaxing train holiday. So when we pass through such amazing destinations, it's only natural you might want to explore and discover a little more of the local attractions. This is why our Off Train Excursions are such a great opportunity.

Off Train Excursions are specially designed to fit in with the train timetable so even if you only have a short time off the train, you'll still have the opportunity to take in some of the area's best sights. So why not take the time to look through the fantastic tours on offer and make the most of your chance to see some of the spectacular attractions. For Off Train Excursions visit www.greatsouthernrail.com.au

Note: Off Train Excursions are not guaranteed and are subject to timetable changes on the day, as required through various Australian rail networks.



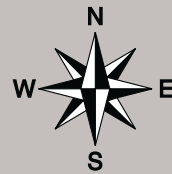

Great Southern Rail Journeys of Discovery

Imagine waking up to see the sun rising over Australia's Red Centre or watching the majestic Blue Mountain slide past. Imagine Australia's fabled Outback unfolding before you, or seeing golden farmlands shimmering in the afternoon light. Whichever way you look at it, there's no other travel experience that compares with seeing this country on board Australia's two great train journeys.

More than simply a mode of transport or a holiday experience, a train journey becomes an unforgettable odyssey. As the carriages weave through the tapestry of the landscape and its rich palette of colours, other travellers – rushing to their destinations at 35,000 feet above you – miss the wonders of the Australian countryside.

In the Top End, find yourself in a land of soaring sandstone cliffs, lush forests and rich Indigenous culture. The ancient mysteries of Katherine Gorge in Nitmiluk National Park are yours to explore through one of three complimentary Off Train Excursions exclusive to guests of The Ghan.

Sit back and watch the horizons expand over South Australia's agricultural heartland. The rugged 540 million year old Flinders Ranges emerge from the distance as the train winds its way to Port Augusta, the crossroads between the Flinders and the rest of your Outback adventure.

Whether you are on The Ghan or Indian Pacific, your holiday begins the moment you step aboard. A choice of service levels offers travellers the opportunity to experience this remarkable land in a style that suits each taste and budget. And when you travel in Platinum or Gold Service, everything – including excursions – is covered by your all-inclusive fare.

Whether you are relaxing in your private cabin or taking it easy in a comfortable Red Service seat, you can take the short stroll to the bar, settle into conversation with fellow travellers, immerse yourself in a good book, or enjoy a relaxing meal with new friends. If travelling in Platinum or Gold Service, this can all be done in the knowledge that your all-inclusive fare takes care of any extra costs for food, drinks or excursions, leaving you free to relax into the journey even more.

After all, it's all about making your journey a true holiday.



Contents

All Inclusive Offering

- 2 Discover the heart of Australia in 2014
- 4 Wining and dining on board

Journeys and Service Levels

- 6 The Ghan
- 8 Indian Pacific
- 10 Private Carriages
- 12 Platinum Service
- 14 Gold Service
- 16 Red Service
- 17 The Overland

Holiday Packages

- 18 The Ghan Holiday Packages
- 26 Indian Pacific Holiday Packages

Optional Touring and Accommodation

- 34 Darwin
- 39 Alice Springs and Uluru
- 44 Adelaide and Coober Pedy
- 50 Sydney and Broken Hill
- 54 Perth

Other Information

- 59 Fares and Timetables
- 63 Frequently asked questions
- 64 Terms and Conditions



Discover the heart of Australia in 2014

See why The Ghan and Indian Pacific are renowned as two of the world's great train journeys, with Off Train Excursions that will show you more of the heart of Australia. Your journey will pause at selected stops to allow you to explore some of the iconic sights of Outback Australia, with insights into the natural and cultural attractions that make this country unique.





Platinum and Gold Service fares on The Ghan and Indian Pacific are inclusive of all meals, beverages and Off Train Excursions.

Offering high levels of service and hospitality and a flexible on-board experience, we put our guests' comfort first, ensuring every experience will be unforgettable. Services are designed to make your next journey into Australia's Outback truly spectacular.

Meal times are flexible and our menus showcase Australia's finest regional produce. And even better – all meals and standard drinks, including beer and wine, soft drinks and spirits, are included in your fare.

Taking a 'foodie' tour of Adelaide's Central Market, cruising the ancient waterway of Katherine Gorge, or getting dust on your boots in the deserts of the Red Centre...all these experiences and more await you on our Off Train Excursions, which are exclusive to Platinum and Gold Service guests and included in the fare.





Wining and dining on board

Whether you're up with the sun – determined not to miss a minute of your trip – or a lover of the lie-in, flexible breakfast times allow you to savour the first meal of the day at your own pace. After all, you are on holiday.



With flexible reservation options, dining aboard The Ghan and Indian Pacific is as easy as booking your lunch and dinner for the time that suits you best. Stay longer over lunch to chat with new friends, or book a table for two for an intimate dinner later in the evening.

Whether it's for breakfast, brunch, lunch or dinner, you'll find the menu brims with choices. Our menus focus on sourcing local food and wine from the regions of Australia we journey through from traditional Eggs Florentine

to Barossa Valley chorizo, Darwin barramundi or Coorong Angus beef or Coffin Bay oysters. You can pair these with fine wines from Australia's beautiful wine regions, such as the Barossa Valley, Hunter Valley and Margaret River.

All standard drinks – wine, beers, soft drinks and spirits – are included for Platinum and Gold Service travellers. Wines are chosen to complement the local specialities.

THE GHAN

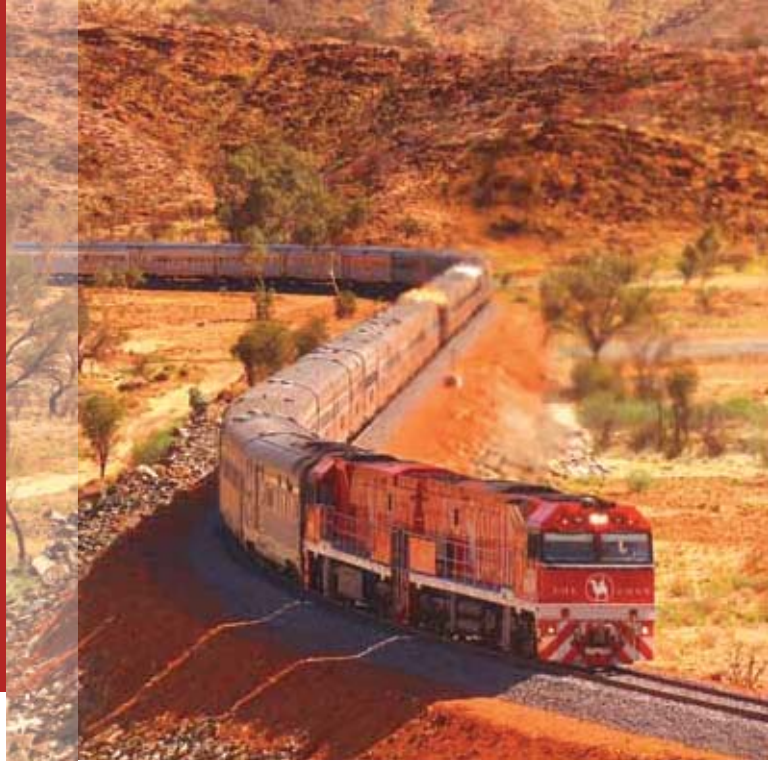

The Ghan

By rail through the red heart to the tropics. You'll never see Australia like this any other way.

The Ghan has been traversing the heart of Australia for more than eighty years. Now it's your turn to explore the continent's vast and remote interior. For three days and two nights, you will discover the Red Centre and the landscapes of this extraordinary land at a relaxing pace, in comfort and style.

Whether you begin in Adelaide or Darwin, your trip will take in the sweeping Adelaide Plains and the majestic Flinders Ranges of South Australia, and the ochre heart of the Red Centre.

Each new day begins with a fresh panorama. Awake to the essence of Central Australia as it takes on a character of its own with each passing hour. At the end of each day, relax with a drink as you soak up the sight of a fiery Outback sunset.

In the Outback melting pot of Alice Springs, you'll have time to explore the town that is home to doctors who fly, camels that race and regattas hosted annually on parched riverbeds. Alice Springs Desert Park makes for an unforgettable stop where you can get up close with Australia's unique flora and fauna.



Follow in the footsteps of the Afghan pioneers who gave The Ghan its name, explore a town full of true-blue Aussie character, and visit attractions including the historic Alice Springs Telegraph Station.

In the Top End, you'll take a cruise to witness the splendour of Katherine Gorge in Nitmiluk National Park and see ancient rock art sites, or try your hand at spear throwing and Indigenous painting on a cultural tour. After all this, you'll arrive in the vibrant tropical capital of Darwin, where even more adventures await.

The Journey

Adelaide to Darwin or vice versa –
Two nights and three days via Alice Springs and Katherine, one way, 2,979km.

Darwin to Alice Springs or vice versa –
One night and two days via Katherine, one way, 1,420km.

Adelaide to Alice Springs or vice versa –
One night and two days, one way, 1,559km.

Service levels available:



Did you know?

Alice Springs is around 460km from Uluru (Ayers Rock). But we make it easy for you to break your journey and spend even longer getting to know the mysteries of the intriguing Red Centre.

See pages 18-25 for suggested holiday packages.





Indian Pacific

The Indian Pacific offers travellers one of the most impressive and indulgent ways to explore the vastness of Australia.

From the Indian Ocean on Australia's western shores to the Pacific on the east – the two oceans that give the train its name – you will watch the passing backdrop of Australia's magnificent landscapes. Travel in either direction – from the 'harbour city' of Sydney in the east or the lovely Western Australian capital, Perth – with a stop in Adelaide along the way.

Connecting three of Australia's most historic cities, the Indian Pacific provides you with a unique window to Outback Australia. It is the journey of a lifetime, from one side of Australia to the other.

Your epic journey will take you through the picturesque and fertile Avon Valley, the dusty goldfields around Kalgoorlie in Western Australia, across the vast and ancient desert of the Nullarbor Plains, to the isolated but intriguing outpost of Cook. Journey through Adelaide and the magnificent and once-impenetrable Blue Mountains.

With our Off Train Excursions you will have time to experience the incredible diversity of Australia. Visit the heritage and culture of the 'Silver City', Broken Hill famous for mining, acclaimed Outback artist Pro Hart and the many hotels including the Palace Hotel

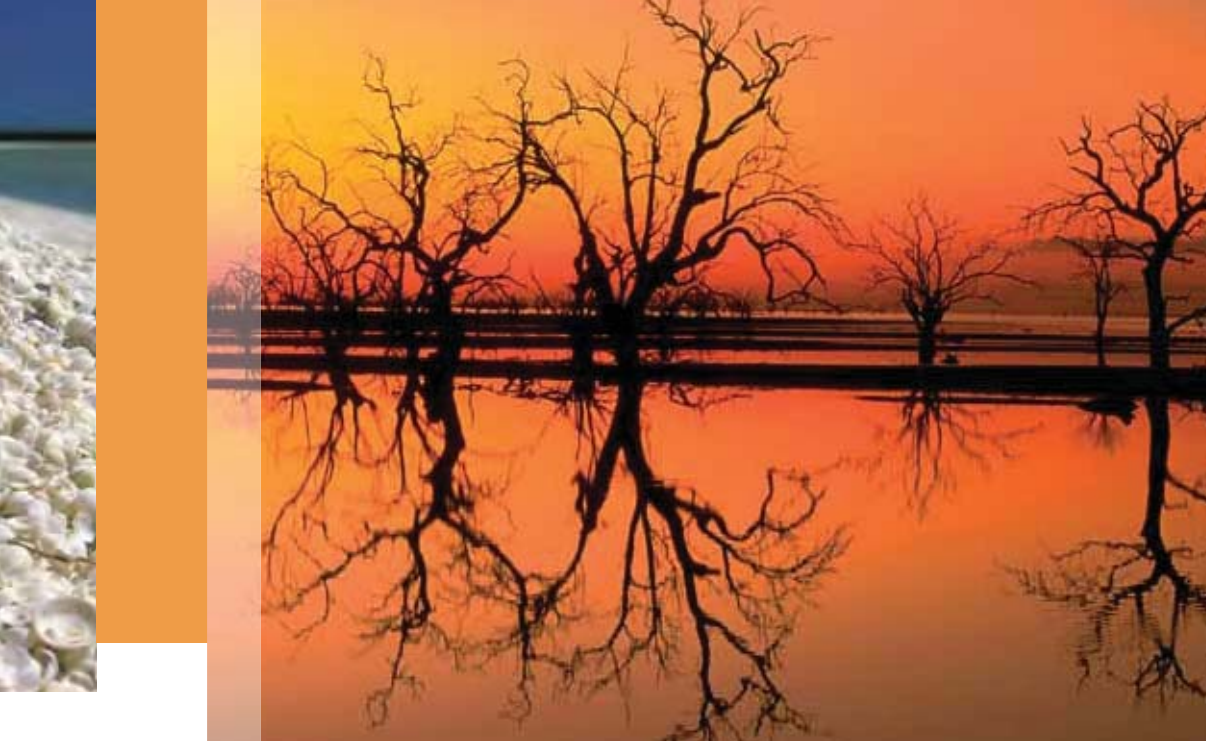

(of Priscilla Queen of the Desert fame). In the elegant South Australian capital, Adelaide, indulge yourself with a gourmet tour of the Central Market or discover its history and culture on a city tour. In Outback Kalgoorlie you'll be astounded at the aptly-named 'Super Pit', an insight into just how big the mining business is!

The Journey

Sydney to Perth or vice versa –
Three nights and four days via Broken Hill, Adelaide, Cook and Kalgoorlie, one way, 4,352km.

Sydney to Adelaide or vice versa –
One night and two days via Broken Hill, one way, 1,693km.

Perth to Adelaide or vice versa –
Two nights and three days via Cook and Kalgoorlie, one way, 2,659km.

Service levels available:



Did you know?

You can break your journey in Adelaide. Why not stay for a week to discover the Barossa Valley, Murray River and Kangaroo Island.

See pages 26-33 for suggested Holiday Packages.





Private Carriages

For business or pleasure, the ultimate in luxury rail travel.

For a truly unforgettable journey, nothing compares to the indulgence, spaciousness and exclusivity of travelling in your own private rail carriage.

Great Southern Rail boasts two Private Carriages in its fleet, available for charters from Sydney, Melbourne, Perth, Adelaide, Alice Springs or Darwin.

For an adventure across the length or breadth of Australia, a Private Carriage aboard The Ghan and Indian Pacific provides the ultimate opportunity to share the excitement and romance

of rail travel with your family or friends. Alternatively, consider coordinating a work conference with a difference by booking a daylight journey aboard The Overland.

The deluxe Sir John Forrest Carriage features wide picture windows and a generous lounge area that can be converted into a spacious boardroom ideal for executive meetings or corporate events. Up to six guests can enjoy comfortable accommodation in two twin cabins and one double cabin, each with individual en suites.



Sir John Forrest Carriage - floor plan



The Chairman's Carriage - floor plan

The elegantly-appointed Chairman's Carriage offers a private dining room and kitchen, spacious living area and accommodation for up to eight guests across two double cabins and two twin cabins.

Your Private Carriage experience comes with all the advantages of Platinum Service travel, including chauffeured transfers at the start and conclusion of your journey, increased luggage allowances, priority selection for a range of Off Train Excursions and all inclusive restaurant dining in the Queen Adelaide Restaurant.

Guests are welcome to socialise with fellow guests over complimentary standard beverages in the Outback Explorer Lounge or relax in the comfort of their own living area, which includes a well-stocked mini bar, plasma screen and DVD and CD players.

Special arrangements can be accommodated to provide a completely personalised travel experience for your celebration or event.



All onboard meals with regional menu.



Standard alcoholic/non alcoholic beverages.



Increased rail luggage allowance.



Off Train Excursions.



Private Transfers.



During the day, our cabin will be configured as a private lounge, with deluxe lounge seating, a table and two ottomans. By night, they convert to a comfortable bedroom, with either a double bed or twin beds.



Platinum Cabin by day

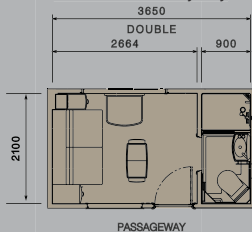

PASSAGEWAY

Platinum Cabin by night

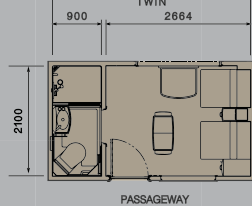

PASSAGEWAY

Platinum Cabin by night

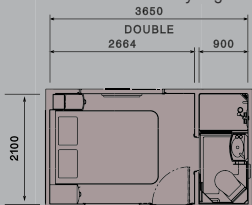

PASSAGEWAY

Platinum Cabin by night

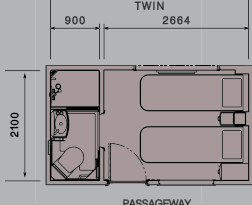

PASSAGEWAY

Platinum Service

Service befitting the rail experience of a lifetime.

Exclusivity and elegance are synonymous with Platinum Service travel. You'll feel pampered and warmly welcomed as you take the best seat in the house.

With dedicated cabin steward service, in-cabin music, journey commentary and much more, Platinum Service is designed to make your rail adventure truly unbeatable.

From your private cabin, you won't miss a thing as the world rolls by outside. Expansive panoramic windows frame the landscape, and all cabins also have an interior window, allowing views from both sides of the train.

Each spacious private cabin has a full en suite. At almost double the size of Gold Service cabins, they have premium fittings, a shower, vanity with ample cupboard space, mirror, toilet facilities and an in-cabin safe.

Platinum Service guests can pre-board the train and relax in the Outback Explorer Lounge before departure at selected locations. Make yourself comfortable, enjoy a cool drink and meet your host and fellow travellers.



Platinum and Gold Service guests dine in the exclusive and elegant Queen Adelaide Restaurant, where delicious fresh Australian cuisine is prepared by on-board chefs.

Three meals a day are served: full or continental breakfasts, sumptuous lunches and a la carte dinners. Meals are accompanied by a selection of fine Australian wines or other beverages, included in your fare.

Explore parts of Australia along the way with our inclusive Off Train Excursions. Visit the Top End's magnificent Katherine Gorge, get to know legendary Alice Springs, see the Western Australia mining town of Kalgoorlie, Adelaide, the foodies paradise and explore the Outback city of Broken Hill.

Not good at travelling light? Don't worry, we've got it covered. The luggage allowance for all Platinum Service guests is a generous three pieces, weighing up to 25kg per piece. We recommend keeping a small bag in your cabin and storing the remainder of your belongings in our secure luggage carriage.

To top-off this premium Platinum Service experience, private transfers are provided at the start and conclusion of your journey. It's all about making your journey an unforgettable experience.



All onboard meals with regional menu.



Standard alcoholic/non alcoholic beverages.



Increased rail luggage allowance.



Off Train Excursions.



Private Transfers.



Gold Service

The romance of a bygone era with every modern comfort.

Whether you're a solo traveller, a couple, or travelling with friends, Gold Service will fulfil your expectations for a stylish journey and make your trip even more memorable.

Our comfortable cabins allow a choice of format. You can select a twin cabin configured as a three-seater lounge during the day and converting to upper and lower berths at night, with compact en suite facilities in your cabin.

If you're travelling alone, single cabins are configured as a lounge chair, converting to a bed at night, with shared bathroom facilities at the end of each carriage. Gold Service Single fares are also fully inclusive of all dining, standard beverages and Off Train Excursions.

Gold Service guests can enjoy pre-boarding the train and relaxing in the Outback Explorer Lounge before departure at selected locations. Make yourself comfortable, enjoy a welcome drink and meet your host and fellow travellers. You'll start to relax from the moment you step aboard.



Platinum and Gold Service guests dine in the exclusive Queen Adelaide Restaurant, where on-board chefs prepare distinctively Australian dishes. Full or continental breakfasts start the day, followed later by delicious lunches and fine a la carte dinners.

Freshly-prepared gourmet meals are accompanied by a selection of Australian wines and beverages, included in your fare.

Before or after dinner – or at any time of day – head to the relaxing Outback Explorer Lounge for a chat with fellow travellers, or to enjoy a nibble or a drink.

As a Gold Service guest, your fare also includes our Off Train Excursions at key points along your journey. Explore parts of Australia you've always wanted to see with memorable outings to Katherine Gorge, Alice Springs, Kalgoorlie, Adelaide and Broken Hill, depending on which journey you are taking.

We know that taking everything you need for your travels is essential to your comfort, so we provide a generous luggage allowance for all Gold Service guests, of two pieces, each of up to 25kg each.

We recommend keeping a small bag in your cabin and storing the remainder of your belongings in our secure luggage carriage.

Travelling Solo?

We offer an all year round standard discount off the Gold Service twin per person fare. With absolutely no single supplements on point-to-point rail travel in our Single Cabins. Our journeys offer fun, group oriented Off Train Excursions and the ability to make friends and socialise in the Outback Explorer Lounge or over dinner.



All onboard meals with regional menu.



Standard alcoholic/non alcoholic beverages.



Increased rail luggage allowance.



Off Train Excursions.



Gold Twin Berth Sleeper by day



Gold Twin Berth Sleeper by night



Gold Single Berth Sleeper by day



Gold Single Berth Sleeper by night



Red Service

A level of comfort to suit your travel style and budget.

Red Service provides travellers with the most economical way to travel without skimping on the important things like travelling in comfort, great food and beverages and most of all, a memorable rail experience.

The Red Service Day/Nighter Seats are two-abreast reclining chairs that can swivel to face each other if you're travelling in a group, or socialising with new-found friends. When you are ready to sleep, recline your chair to a comfortable 45 degree angle and settle in. Your shared toilet and shower facilities are located at the end of your carriage.

During the day, make your way to the Matilda Café, a great place to watch the passing scenery from the panoramic windows, purchase affordable, tasty light meals and enjoy a drink or two with friends.

The experience doesn't end here. Red Service guests are welcome to explore dedicated stops by purchasing their preferred tour from our friendly hospitality staff.



The Overland

Linking with The Ghan and Indian Pacific, The Overland is your gateway to an exciting Australian rail experience.

Connecting Australia's south-eastern cities, The Overland offers a relaxing and comfortable way to travel between Melbourne and Adelaide, and return.

The Overland is the gateway for your ultimate rail adventure, giving you the chance to access The Ghan from Adelaide to Darwin, or the Indian Pacific from Adelaide to Perth.

The Overland is a train rich with Australian history. Its name is inspired by the 'Overlanders', who travelled this fascinating countryside route on horseback. More than a century later, the modern-day 'Overlanders' enjoy the sights of the rugged mallee scrubland, fields of golden crops and vast open plains in relaxed comfort.

The historic one-day journey is the perfect introduction to your Australian rail experience.



The Journey

Melbourne to Adelaide or vice versa – One day, one way, 828km.

Did you know?

The Overland is a fun and hassle-free way to get to major events such as AFL games and theatre productions in Melbourne or the Tour Down Under and music festivals in Adelaide.

The Ghan

Holiday Packages

Travelling through the fiery heart of Australia, The Ghan makes its way north from Adelaide towards the tropical city of Darwin as you marvel at the ever changing scenery of this great southern land. The landscape changes from the wheat fields of the south to the arid desert of Central Australia and onto the lush tropics of the Top End.

Whether looking for a holiday packed with exploration and adventure, or one of ultimate rest and relaxation, there is a holiday package on The Ghan to suit any traveller. Take advantage of guided touring and accommodation to discover world famous regions such as Uluru (Ayers Rock), Kings Canyon, Kata Tjuta (The Olgas) and much more.

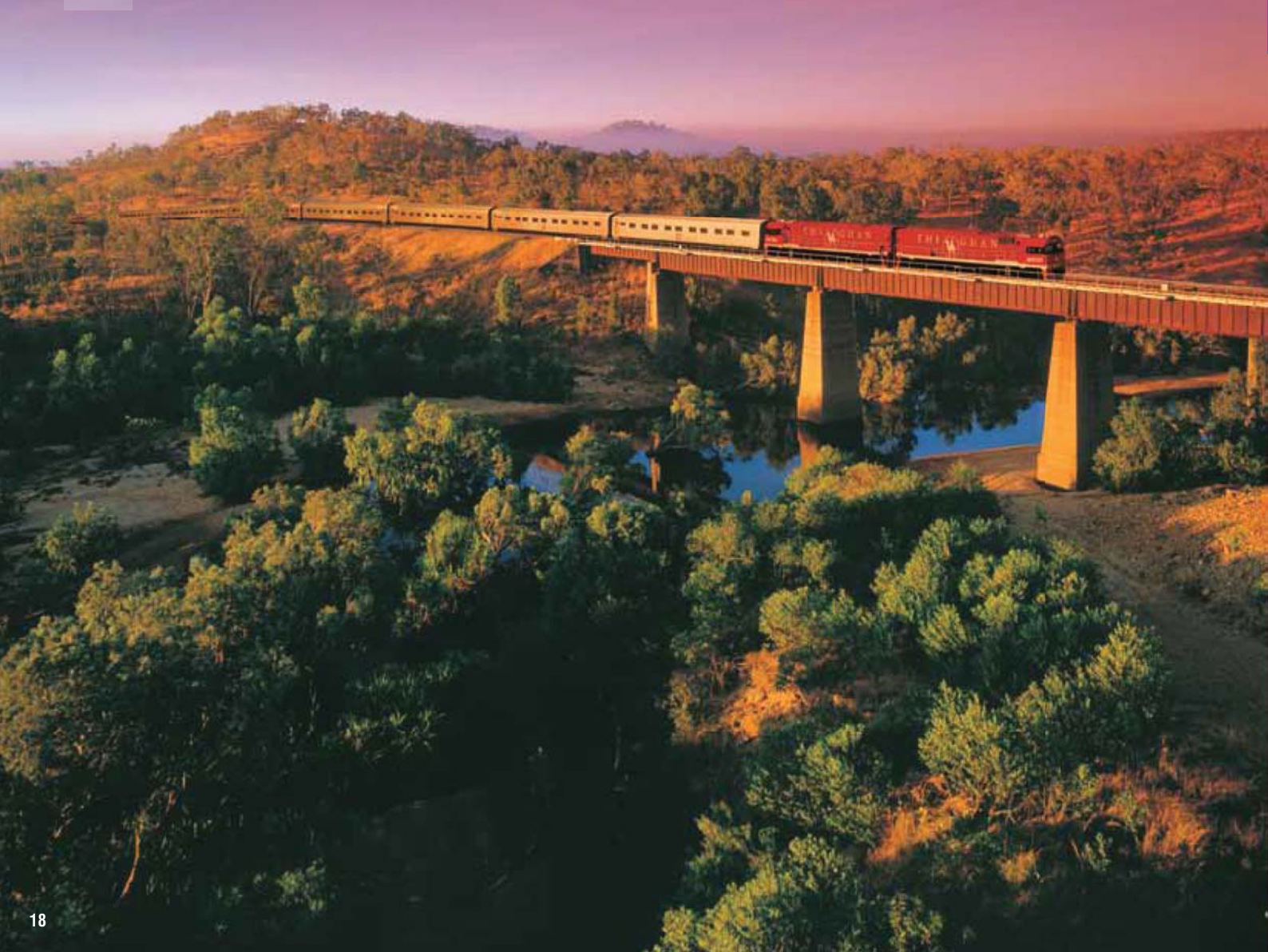

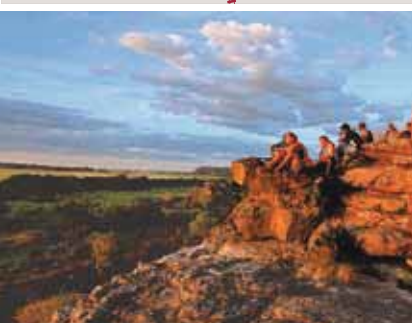
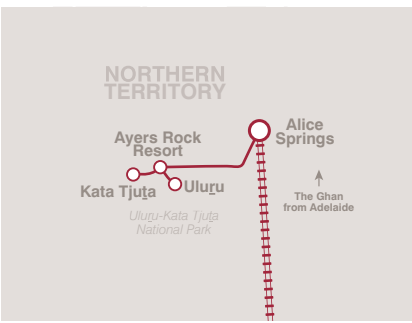

Rock and Rail

5 Days 4 Nights

Alice Springs, Uluru, Kata Tjuta and Outback

Day 1: Sunday or Wednesday

The Ghan: Join The Ghan in Adelaide. Settle in as you travel north towards Spencer Gulf and Port Augusta. (D)

Day 2: Monday or Thursday

Outback and Alice Springs: Enjoy views of the Central Australian desert as you journey to Alice Springs. Transfer to the Aurora Alice Springs, your base for the next two nights. (BL)

Day 3: Tuesday or Friday

Alice Springs: With the whole day free, you can relax, shop and explore at your own pace. (B)

Day 4: Wednesday or Saturday

Uluru: Travel through the rugged West MacDonnell Ranges on your way to Uluru. Check in to your overnight accommodation, the Desert Gardens Hotel. Visit the Cultural Centre and Maruku Arts and Craft Cooperative. Join a guided walk to Mutitjulu Waterhole, view cave paintings and

hear the ancient legends of Kuniya Tjukurpa (Python Dreaming). Tour the base of Uluru and discover the Mala Walk. (B)

Day 5: Thursday or Sunday

Uluru and Kata Tjuta: See a completely new side of Uluru this morning at sunrise. Travel to the mystical domes of Kata Tjuta. Join a guided walk into Walpa Gorge and marvel at the sheer walls. Learn of the domes' formation and of the wildlife of the region. Your holiday concludes at Ayers Rock Resort or the airport after midday, if you'd like to see more, you can easily add extra nights.

Reverse Itinerary: Uluru (ex Adelaide) departs on Monday or Thursday. Uluru (ex Darwin) departs on Monday or Friday.

Alternative Departure: Darwin departs on Saturday or Wednesday.

Booking code: 8AU13/DU13

Includes

- One night on board The Ghan, Gold Service private cabin.
- Transfers in Alice Springs and Uluru.
- Two nights accommodation in Alice Springs.
- Two day Central Australia touring by luxury coach including Uluru sunrise and sunset tours, guided Mala Walk, tour to Kata Tjuta including walking at Walpa Gorge and accommodation.
- All meals as specified in your itinerary: (B) breakfast, (L) lunch, (D) dinner.

Fares

Total package per person twin share from (\$)

Adelaide to Uluru

Days	5
Adult pp	\$2123
Adult single	\$2375
Pen/CSHC pp	\$1706
Pen/CSHC single	\$2000

Adults can save up to \$250 during Dec-Mar when using The Ghan Low Season Fare.

Kakadu Splendour

6 Days 5 Nights

Darwin, Kakadu, Katherine and Alice Springs

Day 1: Sunday or Wednesday

Darwin: Make your own way to Darwin and check in to SKYCITY Darwin for your overnight stay.

Day 2: Monday or Thursday

Kakadu, Nourlangie Rock and Yellow Water Billabong: Heading deep into Kakadu National Park, you'll take a guided walk to view ancient Aboriginal rock art at Nourlangie Rock, see the famous Yellow Water Billabong where you'll enjoy a fantastic wildlife cruise. Stay overnight at Kakadu's Gagudju Crocodile Holiday Inn. (BL)

Day 3: Tuesday or Friday

Ubirr Art Site and East Alligator River: Visit the superb rock art site at Ubirr. Join an Aboriginal guided cruise on the East Alligator River and take in the stunning views across the Kakadu Wetlands. Visit Bowali Visitor Centre before an opportunity to take a scenic flight over the Arnhem Land escarpment (additional cost). Return to Darwin and your overnight accommodation at SKYCITY Darwin. (L)

Day 4: Wednesday or Saturday

The Ghan and Katherine: Travel south to Katherine where you can enjoy an Off Train Excursion at Katherine Gorge. Reboard The Ghan for your overnight journey to Alice Springs. (BLD)

Day 5: Thursday or Sunday

Alice Springs: On arrival in Alice Springs, join an Off Train Excursion before reboarding The Ghan and enjoying the desert scenery as you continue your journey south overnight. (BLD)

Day 6: Friday or Monday

Adelaide: Your holiday concludes on arrival in Adelaide. (B)

Reverse Itinerary: Adelaide departs on Sunday or Wednesday.

Booking code: 30DA11/AD11

Includes

- Two nights on board The Ghan, Gold Service private cabin.
- Two nights accommodation in Darwin.
- Two day tour to Kakadu including Yellow Water wildlife cruise, Aboriginal rock art, culture and accommodation.
- Hotel to station transfer in Darwin.
- All meals as specified in your itinerary: (B) breakfast, (L) lunch, (D) dinner.

Fares

Total package per person twin share from (\$)

Darwin to Adelaide or v.v.

Days	6
Adult pp	\$3174
Adult single	\$3209
Pen/CSHC pp	\$2424
Pen/CSHC single	\$2539

Adults can save up to \$470 during Nov-Mar when using The Ghan Low Season Fare.



Darwin and the Rock

6 Days 5 Nights

Darwin, Katherine, Alice Springs, Uluru and Kata Tjuta

Day 1: Tuesday

Darwin: Make your own way to Darwin and check in to SKYCITY Darwin for your overnight stay.

Day 2: Wednesday

The Ghan and Katherine: Travel south to Katherine where you can enjoy an Off Train Excursion at Katherine Gorge. Reboard The Ghan for your overnight journey to Alice Springs. (BLD)

Day 3: Thursday

Alice Springs: Arrive in Alice Springs and transfer to your overnight accommodation at Lasseters Hotel Casino. (B)

Day 4: Friday

Uluru: Travel through the West MacDonnell Ranges. Stop at the Outback Camel Farm then continue to Ayers Rock Resort. This afternoon travel to the Cultural Centre. Visit the Maruku Arts and Craft Cooperative.

Join a guided walk to the waterhole of Mutitjulu. Tour the base of Uluru before watching the sun set. Return to Ayers Rock Resort, Outback Pioneer Hotel. (B)

Day 5: Saturday

Uluru, Kata Tjuta and Alice Springs: Enjoy a tea or coffee as the sun's first rays strike Uluru. Join a tour to the magnificent domes of Kata Tjuta (Olgas) and walk into Walpa Gorge. Depart Ayers Rock Resort for your return journey to Alice Springs and your overnight accommodation at Lasseters Hotel Casino.

Day 6: Sunday

Alice Springs: Enjoy breakfast at the hotel before checking out. (B)

Reverse Itinerary: Alice Springs departs on Friday.

Booking Code: 133DAS/ASD

Includes

- One night on board The Ghan, Gold Service private cabin.
- One nights accommodation in Darwin.
- Two nights accommodation in Alice Springs.
- Two day tour to Uluru and Kata Tjuta including walking at Walpa Gorge, sunset and sunrise at Uluru and accommodation.
- Station transfers in Darwin and Alice Springs.
- All meals as specified in your itinerary: (B) breakfast, (L) lunch, (D) dinner.

Fares

Total package per person twin share from (\$)

Darwin to Alice Springs or v.v.

Days	6
Adult pp	\$2299
Adult single	\$2601
Pen/CSHC pp	\$1866
Pen/CSHC single	\$2210

Adults can save up to \$250 during Dec-Mar when using The Ghan Low Season Fare.

Darwin, Uluru and Kings Canyon

7 Days 6 Nights

Darwin, Katherine, Alice Springs, Uluru and Kings Canyon

Day 1: Tuesday

Darwin: Make your own way to Darwin and check in to the Darwin Central Hotel for your overnight stay.

Day 2: Wednesday

The Ghan and Katherine: Travel south to Katherine where you can enjoy an Off Train Excursion at Katherine Gorge. (BLD)

Day 3: Thursday

Alice Springs: Arrive in Alice Springs and transfer to DoubleTree by Hilton Alice Springs. (B)

Day 4: Friday

Uluru: Travel through the West MacDonnell Ranges. Stop at the Outback Camel Farm, before arriving at Ayers Rock Resort. This afternoon, join a guided walk to Mutitjulu Waterhole. Tour the base of Uluru on the Mala Walk. Travel to sunset strip to view Uluru before returning to Ayers Rock Resort, Desert Gardens Hotel. (B)

Day 5: Saturday

Uluru, Kata Tjuta & Kings Canyon: Rise early to watch the sun cast its first rays on Uluru. Travel to the immense 36 rock domes of Kata Tjuta. Enjoy a guided walk into Walpa Gorge. This afternoon travel to Kings Canyon. Overnight at the Kings Canyon Resort.

Day 6: Sunday

Kings Canyon and Alice Springs: Enjoy a guided walk to the rim of Kings Canyon or alternatively, join an easier walk along the canyon floor. Continue on to Alice Springs, stopping en route at Kings Creek Cattle Station. Overnight at DoubleTree by Hilton Alice Springs.

Day 7: Monday

Alice Springs: Enjoy breakfast at the hotel before checking out. (B)

Reverse Itinerary: Alice Springs departs on Thursday.

Booking Code: 34DAS/ASD

Includes

- One night on board The Ghan, Gold Service private cabin.
- One nights accommodation in Darwin.
- Two nights accommodation in Alice Springs.
- Three day tour to Uluru, Kata Tjuta and Kings Canyon including walking at Walpa Gorge, sunset and sunrise at Uluru, walking at Kings Canyon and accommodation.
- Station transfers in Darwin and Alice Springs.
- All meals as specified in your itinerary: (B) breakfast, (L) lunch, (D) dinner.

Fares

Total package per person twin share from (\$)

Darwin to Alice Springs or v.v.

Days	7
Adult pp	\$2717
Adult single	\$3237
Pen/CSHC pp	\$2265
Pen/CSHC single	\$2827

Adults can save up to \$250 during Dec-Mar when using The Ghan Low Season Fare.



Flinders Ranges Adventure

5 Days 4 Nights

Wilpena Pound Resort, Gorgeous Gorges and Scenic Flight

Day 1: Wednesday or Saturday

The Ghan and Katherine: Join The Ghan in Darwin and travel south to Katherine where you can enjoy an Off Train Excursion of Katherine Gorge. Reboard the train for your overnight journey to Alice Springs. (LD)

Day 2: Thursday or Sunday

Alice Springs and Outback: Arrive in Alice Springs, join an Off Train Excursion before reboarding the train. (BLD)

Day 3: Friday or Monday

Port Augusta and Wilpena Pound Resort: On arrival in Port Augusta, you will be met by your guide to begin your Flinders Ranges Escape. Enjoy a two hour Port Augusta river cruise, before travelling by road to Wilpena Pound to your base for the next two nights at Wilpena Pound Resort. This afternoon is at your leisure. Take an easy walk into the Pound or simply relax in the surroundings. (B)

Day 4: Saturday or Tuesday

Brachina and Bunyerroo Gorges: After breakfast, depart on your 4WD tour. Explore the rugged beauty of Brachina and Bunyerroo Gorges. Search for Yellow Footed Rock Wallabies and enjoy sweeping views of Bunyerroo Valley. This afternoon join your scenic flight which provides a fantastic view of the surrounds; see Wilpena Pound from the air with the resort nestled in among the River Red Gums. (B)

Day 5: Sunday or Wednesday

Wilpena Pound Resort and Adelaide: Take in any last minute sights before departing Wilpena Pound Resort for your journey to Adelaide. Stop in the Clare Valley for a light lunch before arriving in Adelaide mid afternoon where your holiday ends. (BL)

Booking Code: 40DA

Includes

- Two nights on board The Ghan, Gold Service private cabin.
- Port Augusta eco river cruise.
- Transfer to Wilpena Pound Resort.
- Two night Flinders Ranges Escape package including breakfast, half day 4WD tour, scenic flight and accommodation.
- Transfer to Adelaide via the Clare Valley.
- All meals as specified in your itinerary: (B) breakfast, (L) lunch, (D) dinner.

Fares

Total package per person twin share from (\$)

Darwin to Adelaide	
Days	5
Adult pp	\$3580
Adult single	\$3528
Pen/CSHC pp	\$2853
Pen/CSHC single	\$2881

Adults can save up to \$470 during Dec-Mar when using The Ghan Low Season Fare.

Outback Gem

6 Days 5 Nights

Coober Pedy, Desert Cave, Painted Desert and Opals

Day 1: Wednesday

The Ghan: Join The Ghan in Darwin and travel south to Katherine. Enjoy a spectacular Off Train Excursion at Katherine Gorge, then hop back onboard for your overnight journey to Alice Springs. (LD)

Day 2: Thursday

Alice Springs and Coober Pedy: After arriving in Alice Springs, you'll have time to join an Off Train Excursion before reboarding the train to Manguri (Coober Pedy). On arrival you will be met and transferred to the Desert Cave Hotel in Coober Pedy, your base for the next four nights. (BLD)

Day 3: Friday

Desert Cave Town: Tour the town, hear about its history, about the previous water supplies and power generation. Visit a working opal field to see opal mining methods, see the Breakaways and the famous Dog (Dingo) Fence. (B)

Day 4: Saturday

Painted Desert: Travel by 4WD over the ancient sea bed, known as Moon Plains, to the spectacular country of the Painted Desert. See some of the vast cattle stations of the Outback, bush walk through the Painted Desert and experience the beauty of Outback landscapes and waterholes. (BL)

Day 5: Sunday

Down and Dirty Opal: Visit a working mine field to understand the various styles of opal mining. Don a hard hat, torch and handpick to get down and dirty fossicking for your own fortune. (B)

Day 6: Monday

Coober Pedy: Enjoy one last breakfast before transferring to the Coober Pedy airport for your flight to Adelaide. (B)

Booking Code: 32DA

Includes

- One night on board The Ghan, Gold Service private cabin.
- Four nights accommodation in Coober Pedy.
- Half day Desert Cave Town tour.
- Touring of the Painted Desert including the Dingo Fence and Moon Plains.
- Half day Down and Dirty Opal tour.
- Flight, Coober Pedy to Adelaide.
- All meals as specified in your itinerary: (B) breakfast, (L) lunch, (D) dinner.

Fares

Total package per person twin share from (\$)

Darwin to Adelaide	
Days	6
Adult pp	\$4011
Adult single	\$4343
Pen/CSHC pp	\$3284
Pen/CSHC single	\$3696

Adults can save up to \$470 during Nov-Mar when using The Ghan Low Season Fare.

Track The Red Centre

7 Days 6 Nights

Alice Springs, Uluru, Kata Tjuta and Kings Canyon

Day 1: Sunday or Wednesday

The Ghan: Join The Ghan in Adelaide. Settle in as you journey north towards Spencer Gulf and Port Augusta. Enjoy dinner in the Queen Adelaide Restaurant, meet your fellow travellers in the Outback Explorer Lounge or simply enjoy the views from your private cabin. (D)

Day 2: Monday or Thursday

Outback, Alice Springs and Mt Conner: On arrival in Alice Springs you will be met by your guide to commence your ultimate Red Centre small group touring experience. Discover Mt Conner, also known as Attila, a flat-topped and horseshoe shaped mountain, before arriving at Ayers Rock Resort, your base for the next two nights. (BLD)

Day 3: Tuesday or Friday

Kata Tjuta and Uluru: Revel in the early morning serenity of Kata Tjuta. See the 36 domes that comprise this spiritual place. Take a walk into the valley between the massive red conglomerate rocks. Return to Ayers Rock Resort before joining your sunset tour to Uluru. Visit Mutitjulu Waterhole, learn of the Creation stories and see ancient rock art before settling in to watch the setting sun bring out the many colours of Uluru. (BD)

Day 4: Wednesday or Saturday

Kings Canyon: Travel to Kings Canyon. For the adventurous at heart, climb the escarpment on the Rim Walk or alternatively, join an easier walk along the boulder-strewn, shady Canyon floor where at the end is a platform with views of the Canyon walls above. Marvel at the Canyon walls rising more than 300 metres from the valley floor. Stay overnight at Kings Canyon Wilderness Lodge or similar. (BLD)

Day 5: Thursday or Sunday

Alice Springs: Tour from Kings Canyon to Alice Springs today. On arrival in Alice Springs, you will be transferred to DoubleTree by Hilton Alice Springs, your base for the next two nights. (B)

Day 6: Friday or Monday

Alice Springs: Today is yours to enjoy at leisure. (B)

Day 7: Saturday or Tuesday

Alice Springs: Enjoy breakfast at the hotel before checking out. (B)

Reverse Itinerary: Alice Springs departs on Saturday.

Alternative Departure: Darwin departs on Wednesday.

Booking Code: 9AAS/DAS

Includes

- One night on board The Ghan, Gold Service private cabin.
- Three day 'Track the Red Centre' tour including small group touring, meals, National Park entry fees, return transfers and accommodation.
- Two nights accommodation in Alice Springs.
- All meals as specified in your itinerary: (B) breakfast, (L) lunch, (D) dinner.

Fares

Total package per person twin share from (\$)

Darwin or Adelaide to Alice Springs or v.v.

Days	7
Adult pp	\$4617
Adult single	\$5779
Pen/CSHC pp	\$4239
Pen/CSHC single	\$5443

Adults can save up to \$250 during Nov-Mar when using The Ghan Low Season Fare.

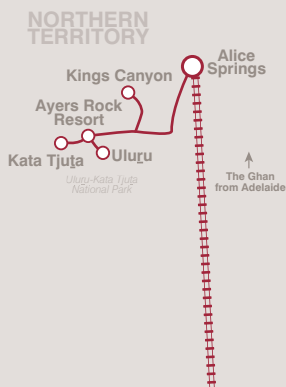



Taste of the Top End

Darwin, Jumping Crocodiles Cruise, Katherine and Alice Springs

Day 1: Sunday or Wednesday

The Ghan: Join The Ghan in Adelaide. Settle in as you journey north towards Spencer Gulf and Port Augusta. Enjoy dinner in the Queen Adelaide Restaurant, meet your fellow travellers in the Outback Explorer Lounge or simply enjoy the views from your private cabin. (D)

Day 2: Monday or Thursday

Outback and Alice Springs: After arriving in Alice Springs, you'll have time to enjoy an Off Train Excursion before reboarding The Ghan and continuing your journey north overnight. (BLD)

Day 3: Tuesday or Friday

Katherine and Darwin: Join an Off Train Excursion at Nitmiluk National Park, home to Katherine Gorge and ancient Aboriginal rock art. Hop back onboard for your journey north through the lush, Top End countryside before arriving in Darwin. Transfer to Darwin Central Hotel, your base for the next three nights. (BL)

Day 4: Wednesday or Saturday

Darwin: This morning is free for you to relax in this warm and cosmopolitan city before joining your city sights tour in the afternoon for the perfect introduction to Darwin. See the lush Botanic Gardens and the Chinese Temple, which was re-built after it was totally demolished by Cyclone

Tracy in 1974. Tour the historic sites of the city including the East Point Military Precinct. See the Stokes Hill Wharf area and the Mooring Basin. There is also time available to explore the Museum and Art Gallery of the Northern Territory, whose collections encompass Aboriginal art, visual arts and Northern Territory history and natural sciences. (B)

Day 5: Thursday or Sunday

Darwin and Jumping Crocodiles: Spend the morning at leisure, as this afternoon you are in for a real treat – the famous Adelaide River Jumping Crocodiles cruise. Just 60km from Darwin lies the Adelaide River, home to over 1600 crocodiles and the location of the famous Jumping Crocodiles. Cruise the river and thrill as these awesome creatures launch themselves out of the water. The cruise will enable you to see these prehistoric creatures at close range. Afterwards, continue on to the Window on the Wetlands Visitor Centre for stunning views over the Marrakai Plains and then it's on to Fogg Dam Nature Reserve before returning to Darwin city. (B)

Day 6: Friday or Monday

Darwin: Enjoy breakfast at the hotel before checking out. (B)

Reverse Itinerary: Darwin departs on Wednesday and Sunday.

Booking Code: 50AD/DA

6 Days 5 Nights

Includes

- Two nights on board The Ghan, Gold Service private cabin.
- Station to hotel transfer in Darwin.
- Three nights accommodation in Darwin.
- City tour of Darwin sights.
- Jumping Crocodiles plus Fogg Dam and the Window on the Wetlands tour.
- All meals as specified in your itinerary: (B) breakfast, (L) lunch, (D) dinner.

Fares

Total package per person twin share from (\$)

Adelaide to Darwin or v.v.

Days	6
Adult pp	\$2820
Adult single	\$2861
Pen/CSHC pp	\$2076
Pen/CSHC single	\$2197

Adults can save up to \$470 during Nov-Mar when using The Ghan Low Season Fare.



The Territory Complete

14 Days 13 Nights



Alice Springs, Uluru, Kata Tjuta, Kings Canyon, Katherine, Darwin and Kakadu

Day 1: Sunday or Wednesday

The Ghan: Join The Ghan in Adelaide. Settle in to the comforts of this great train as you travel north to Alice Springs. (D)

Day 2: Monday or Thursday

Alice Springs: On arrival in Alice Springs, transfer to The Chifley Alice Springs Resort. (B)

Day 3: Tuesday or Friday

Alice Springs to Uluru: Travel from Alice Springs to Ayers Rock Resort. This afternoon visit the Uluru sunset viewing area and watch as the evening sky brings out the many shades of colour for which Uluru is famous. Enjoy an Outback BBQ to complete your evening. (BD)

Day 4: Wednesday or Saturday

Kata Tjuta: View sunrise over Uluru before travelling by coach to the Mutitjulu Walk. See Aboriginal rock paintings and learn about the history of Uluru. This afternoon, visit Kata Tjuta and take a walk in the valley between the massive red conglomerate rocks.

Day 5: Thursday or Sunday

Uluru and Kings Canyon: Enjoy the morning at your leisure or join an optional tour. This afternoon, travel to Kings Canyon.

Day 6: Friday or Monday

Kings Canyon: Join a guided climb to the rim of Kings Canyon or alternatively enjoy an easier walk along the Canyon floor. Stop at Kings Canyon Resort before returning to Alice Springs.

Day 7: Saturday or Tuesday

Alice Springs: Today is free to explore at your own pace. (B)

Day 8: Sunday or Wednesday

Palm Valley: A 4WD adventure down Finke River to the oasis setting at Palm Valley then on to Hermannsburg. (BL)

Day 9: Monday or Thursday

The Ghan: Join The Ghan to travel north towards Darwin. (B)

Day 10: Tuesday or Friday

Katherine and Darwin: Stop in Katherine, enjoy an Off Train Excursion. Check in to SKYCITY Darwin for the next two nights. (BL)

Day 11: Wednesday or Saturday

Darwin: Visit the sights of Darwin on your half day city sights tour. (B)

Day 12: Thursday or Sunday

Darwin to Kakadu: Travel deep into Kakadu National Park. Visit Nourlangie Rock to view ancient Aboriginal rock art before joining your cruise on Yellow Water Billabong. (BL)

Day 13: Friday or Monday

Kakadu to Darwin: This morning stop at Ubirr with a short walk to view Aboriginal rock art. Join your Gulyambi Cruise along the East Alligator River with your Aboriginal guide. Visit the Bowali Visitor Centre before returning to Darwin. (L)

Day 14: Saturday or Tuesday

Darwin: Enjoy breakfast at the hotel before checking out. (B)

Booking Code: 37AD11

Includes

- Two nights on board The Ghan, Gold Service private cabin.
- Four nights accommodation in Alice Springs.
- Four day tour to Uluru, Kata Tjuta and Kings Canyon including sunset and sunrise at Uluru, Uluru Aussie Barbecue dinner, guided touring and accommodation.
- Full day Palm Valley tour.
- Three nights accommodation in Darwin.
- Two day tour to Kakadu including Yellow Water wildlife cruise, Aboriginal rock art, culture and accommodation.
- Half day Darwin City Sights.
- Station transfers in Darwin and Alice Springs.
- All meals as specified in your itinerary: (B) breakfast, (L) lunch, (D) dinner.

Fares

Total package per person twin share from (\$)

Adelaide to Darwin

Days	14
Adult pp	\$5574
Adult single	\$6818
Pen/CSHC pp	\$4683
Pen/CSHC single	\$6011

Adults can save up to \$500 during Dec-Feb when using The Ghan Low Season Fare.

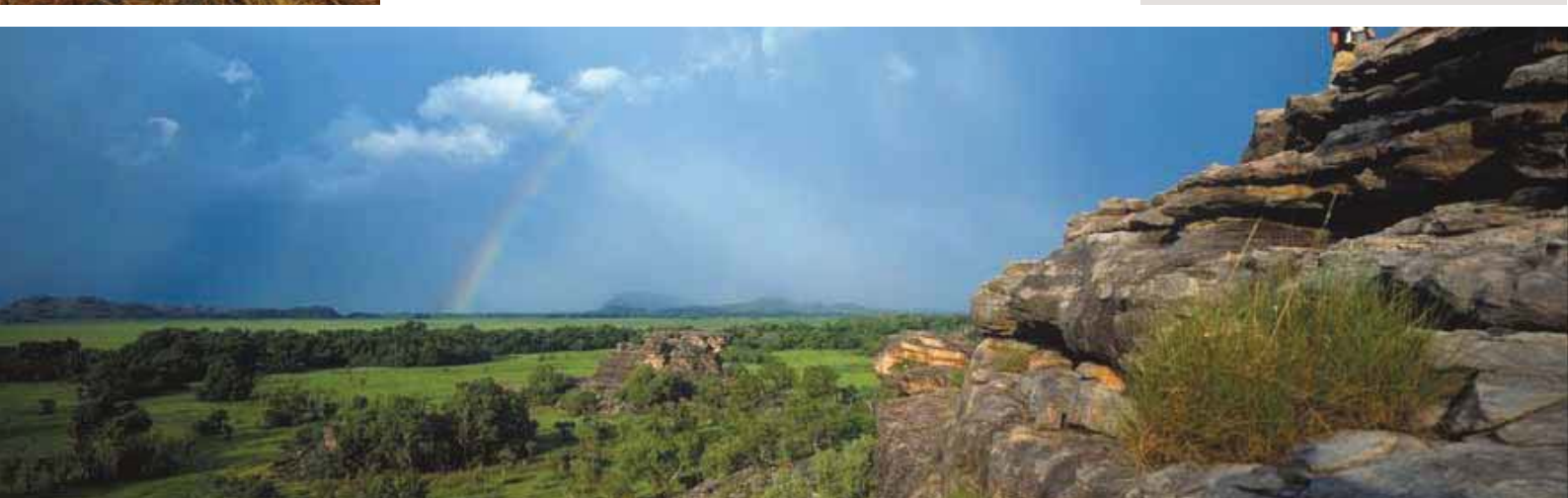



Wildman Kakadu Adventure

9 Days 8 Nights

Wildman Wilderness Lodge, Mary River Rock Hole and Kakadu

Day 1: Thursday

Darwin: Make your own way to Darwin and check in to Hilton Darwin for your overnight stay.

Day 2: Friday

Darwin and Wildman Wilderness Lodge: Explore Darwin this morning before joining your transfer to Wildman Wilderness Lodge, located in the lush Top End of Australia's Northern Territory. This region is renowned for its wildlife, history and Indigenous culture. The Lodge is located on the Mary River Wetlands and surrounded by a seasonal floodplain, year round naturally occurring billabong and natural habitat for hundreds of species of birds and animals. (BD)

Day 3: Saturday

Mary River Rock Hole: This morning enjoy your Mary River Rock Hole cruise. This is an excellent opportunity to see crocodiles, wetland birds and fantastic views across the vast Mary River floodplain. Spend the afternoon relaxing in the main lodge, the focal point of the Resort. If you're feeling energetic, take a walk around the edge of the wetlands, meander through termite fields and freshwater mangroves or alternatively relax on the deck of your Safari Tent. (BD)

Day 4: Sunday

Kakadu: Travel to Kakadu via the Old Jim Jim Road. Stop for morning tea then travel across floodplains and billabongs. Immerse yourself in the Aboriginal history at Waradjin Cultural Centre. Journey on to Burrungui to experience the oldest living culture on earth through ancient rock art and see amazing views of the Arnhem Land

escarpment from Gunwarddehwardde lookout. Stop for a sumptuous picnic lunch at Anbangbang Billabong. Work lunch off with a small hike to Nawurlandja lookout. After this short walk, we travel to Mamukala for a view over the wetlands. (BLD)

Day 5: Monday

Wildman Wilderness Lodge and Darwin: Take in any last minute sights this morning before transferring back to Darwin and the Hilton Darwin, your base for the next two nights. The remainder of the afternoon is free at leisure. (B)

Day 6: Tuesday

Darwin: Today is yours to explore Darwin at your own pace. Visit the Waterfront Precinct, take in a spot of shopping in the mall or simply relax at your accommodation. (B)

Day 7: Wednesday

The Ghan and Katherine: Join The Ghan and travel south to Katherine where you can enjoy an Off Train Excursion of Katherine Gorge. Reboard the train for your overnight journey to Alice Springs. (BLD)

Day 8: Thursday

Alice Springs and Outback: Arrive in Alice Springs this morning, join an Off Train Excursion before reboarding the train and enjoying the desert scenery as you continue your journey south. (BLD)

Day 9: Friday

Adelaide: Your holiday concludes on arrival in Adelaide. (B)

Booking Code: 39DA

Includes

- Two nights on board The Ghan, Gold Service private cabin.
- Three nights accommodation in Darwin.
- Three night Wildman Kakadu Adventure package including breakfast and dinner, Mary River Rock Hole cruise, Kakadu day tour, return transfers and accommodation.
- All meals as specified in your itinerary: (B) breakfast, (L) lunch, (D) dinner.

Fares

Total package per person twin share from (\$)

Darwin to Adelaide - Gold Service

Days	9
Adult pp	\$4263
Adult single	\$5268
Pen/CSHC pp	\$3536
Pen/CSHC single	\$4621

Adults can save up to \$470 during Nov when using The Ghan Low Season Fare.



Indian Pacific

Holiday Packages

Taking its name from the two oceans it travels between, the Indian Pacific is a train journey that travels 4,325km across an entire nation. From Sydney to Perth, or the opposite direction, witness the vast Australian landscape unfold before your eyes as you travel through the majestic Blue Mountains, the picturesque Flinders Ranges and the harsh, lonely desert that is the Nullarbor Plain.

Taking a holiday package on the Indian Pacific means that you will embark on a journey of discovery to some of Australia's best hidden treasures. From wine regions, to Outback expeditions, Australian wildlife, to culinary delights, an Indian Pacific holiday package is the right mixture of adventure and relaxation – a truly perfect way to see Australia.





Sydney Escape

Sydney Highlights, Bondi Beach and Harbour Coffee Cruise

Day 1: Friday or Tuesday

Indian Pacific: Join the mighty Indian Pacific in Adelaide and settle in to the comforts of this great train. Arrive in Broken Hill where you'll have time for an Off Train Excursion before reboarding the train and continuing your journey overnight. (D)

Day 2: Saturday or Wednesday

Sydney: Watch the picturesque views of the Blue Mountains from your window as you weave your way into Sydney. Your accommodation for the next three nights is at the Vibe Hotel Sydney. (B)

Day 3: Sunday or Thursday

Sydney and Bondi Beach: Enjoy the highlights of Sydney, the historical Rocks area and Circular Quay. View the Opera House and Harbour Bridge. Travel through Chinatown and Darling Harbour. Visit the world-famous Bondi Beach. (B)

Day 4: Monday or Friday

Sydney Harbour Coffee Cruise: The coffee cruise shows you all the best of Sydney Harbour from the comfort of your vessel. Enjoy snacks, tea and coffee while cruising the magnificent upper reaches of Middle Harbour where palatial waterfront homes, parks, beaches and marinas show Sydney life at its best. (B)

Day 5: Tuesday or Saturday

Sydney: Enjoy breakfast at the hotel before checking out. (B)

Reverse Itinerary: Sydney departs on Wednesday or Sunday.

Alternative Departure: Perth departs on Wednesday or Sunday.

Booking Code: 6AS/PS

5 Days 4 Nights

Includes

- One night on board the Indian Pacific, Gold Service private cabin.
- Three nights accommodation in Sydney.
- Half day tour of Sydney's highlights and famous Bondi Beach.
- Sydney Harbour Coffee Cruise.
- All meals as specified in your itinerary: (B) breakfast, (L) lunch, (D) dinner.

Fares

Total package per person twin share from (\$)

Adelaide to Sydney or vv	
Days	5
Adult pp	\$1394
Adult single	\$1649
Pen/CSHC pp	\$1224
Pen/CSHC single	\$1489

Perth to Sydney or v.v.	
Days	7
Adult pp	\$3014
Adult single	\$3109
Pen/CSHC pp	\$2261
Pen/CSHC single	\$2433

Three Cities Three Trains

Melbourne, The XPT and Sydney

Day 1: Monday or Friday

The Overland: Travel aboard The Overland enjoying the scenery as the train winds its way through the Adelaide Hills, across the Murray River and past The Grampians before arriving in Melbourne. Your accommodation for the next two nights is at Batman's Hill on Collins.

Day 2: Tuesday or Saturday

Melbourne: Experience the sights of Melbourne this morning. Visit the Fitzroy Gardens and see highlights including Parliament House, Queen Victoria Market, MCG and much more. Finish your tour with a scenic one hour river cruise on the Yarra River. (B)

Day 3: Wednesday or Sunday

Melbourne and The XPT: Today is free to explore the many shops, cafés and sights of Melbourne. This evening join The XPT and settle in to your First Class Sleeper as you journey to Sydney. (B)

Day 4: Thursday or Monday

Sydney: Arrive into Sydney Central Station and make your way to the Travelodge Sydney where you will stay for the next two nights.

Day 5: Friday or Tuesday

Sydney: Join the city hop on - hop off tour today. Stay onboard for a 90 minute guided tour of the city or hop on - hop off all day. (B)

Day 6: Saturday or Wednesday

Indian Pacific: Join the Indian Pacific in Sydney. Settle in to the comforts of this great train. (BD)

Day 7: Sunday or Thursday

Adelaide: Explore Broken Hill on an Off Train Excursion before reboarding the train for your journey to Adelaide. (BL)

Alternative Departures: Sydney departs on Sunday or Thursday. Melbourne departs on Saturday or Tuesday. Perth departs on Sunday.

Booking Code: 1AA/SS/MM11/PA

7 Days 6 Nights

Includes

- Red Premium Service on board The Overland.
- Half day Melbourne City Sights Tour and River Cruise.
- First Class Sleeper on board The XPT.
- Introductory tour of Sydney highlights.
- One night on board the Indian Pacific, Gold Service private cabin.
- Two nights accommodation in both Melbourne and Sydney.
- All meals as specified in your itinerary: (B) breakfast, (L) lunch, (D) dinner.

Fares

Total package per person twin share from (\$)

Adelaide to Adelaide	
Days	7
Adult pp	\$1812
Adult single	\$2280
Pen/CSHC pp	\$1578
Pen/CSHC single	\$2056



Explore Adelaide

Adelaide, North Terrace and Seaside Glenelg

Day 1: Saturday or Wednesday

Indian Pacific: Join the mighty Indian Pacific in Sydney. Settle in to your private cabin, sit back, relax and meet your fellow travellers in the Outback Explorer Lounge. (D)

Day 2: Sunday or Thursday

Broken Hill and Adelaide: Explore the unique Outback city of Broken Hill on an Off Train Excursion before reboarding the Indian Pacific for the rest of your journey to Adelaide. Transfer to your accommodation at Hotel Grand Chancellor Adelaide on Hindley, your base for the next three nights. (BL)

Day 3: Monday or Friday

Adelaide: This morning join your city highlights tour of Adelaide. From the city to the beach, you will experience the daily cosmopolitan life of Adelaide. See iconic cathedrals, the North Terrace cultural boulevard including the SA Museum, Art Gallery, State Library

and Parliament House, visit Colonel Light's Lookout over Adelaide and the world famous Adelaide Oval, before venturing out to Glenelg - the city's bustling beach. With a quick bite at Haigh's Chocolate Factory included, this tour is a great introduction to Adelaide. The remainder of the day is free for you to enjoy as you please. Why not visit Rundle Mall for a spot of shopping or simply relax in the comfort of your accommodation.

Day 4: Tuesday or Saturday

Adelaide: Take in any last minute sights today before your short break concludes.

Reverse Itinerary: Adelaide departs Sunday or Wednesday.

Alternative Departure: Perth to Adelaide departs on Wednesday or Sunday. Adelaide to Perth departs on Tuesday or Friday.

Booking Code: 23SA/PA

4 Days 3 Nights

Includes

- One night on board the Indian Pacific, Gold Service private cabin.
- Two nights accommodation in Adelaide.
- Adelaide city highlights tour.
- All meals as specified in your itinerary: (B) breakfast, (L) lunch, (D) dinner.

Fares

Total package per person twin share from (\$)

Sydney to Adelaide or v.v.

Days	4
Adult pp	\$1080
Adult single	\$1137
Pen/CSHC pp	\$916
Pen/CSHC single	\$983

Perth to Adelaide or v.v.

Days	5
Adult pp	\$2010
Adult single	\$1957
Pen/CSHC pp	\$1447
Pen/CSHC single	\$1458

A Taste of South Australia

Adelaide, McLaren Vale, Adelaide Hills and Barossa Valley Wine Regions

Day 1: Saturday or Wednesday

Indian Pacific: Join the mighty Indian Pacific in Sydney. Settle in, relax and meet your fellow travellers. (D)

Day 2: Sunday or Thursday

Broken Hill and Adelaide: Explore the unique Outback city of Broken Hill on an Off Train Excursion before reboarding the Indian Pacific for the rest of your journey to Adelaide. Transfer to the Majestic Roof Garden Hotel, your base for the next three nights. (BL)

Day 3: Monday or Friday

McLaren Vale and Adelaide Hills Winery Ultimate: The wine regions of McLaren Vale and the Adelaide Hills provide you with the opportunity to delight in the tastes of South Australia. Stop at Fox Creek's Cellar Door with a state of the art wine making facility. Next is The Olive Grove before a delightful lunch at Woodstock Winery. Also visit Longview Winery and Blefari Vineyard before returning to Adelaide. (BL)

Day 4: Tuesday or Saturday

Barossa Valley Supreme: Discover the flavours of the world famous Barossa Valley wine region. Visit the well-known Wolf Blass Winery and Maggie Beer's Farm Shop to sample her gourmet pâtés and the Beer Brothers wines. Enjoy the best foods the region has to offer. Sit back, take in the ambience and the views before visiting Langmeil Winery and Chateau Tanunda. (BL)

Day 5: Wednesday or Sunday

Adelaide: Enjoy breakfast at the hotel before checking out. (B)

Alternative Departure: Perth to Adelaide departs on Wednesday or Sunday. Perth to Sydney departs on Wednesday.

Booking Code: 59SA/PA

5 Days 4 Nights

Includes

- One night on board the Indian Pacific, Gold Service private cabin.
- Station to hotel transfer in Adelaide.
- Three nights accommodation in Adelaide.
- McLaren Vale and Adelaide Hills Winery Ultimate tour.
- Barossa Valley Supreme tour.
- All meals as specified in your itinerary: (B) breakfast, (L) lunch, (D) dinner.

Fares

Total package per person twin share from (\$)

Sydney to Adelaide

Days	5
Adult pp	\$1467
Adult single	\$1647
Pen/CSHC pp	\$1297
Pen/CSHC single	\$1487

Perth to Adelaide

Days	7
Adult pp	\$2515
Adult single	\$2675
Pen/CSHC pp	\$1946
Pen/CSHC single	\$2170



The West Coaster

Adelaide, the Nullarbor, Perth and Fremantle

Day 1: Saturday or Wednesday

Indian Pacific: Join the mighty Indian Pacific in Sydney. (D)

Day 2: Sunday or Thursday

Broken Hill and Adelaide: Explore Broken Hill on an Off Train Excursion before reboarding the Indian Pacific to Adelaide. In Adelaide there's time for another Off Train Excursion before heading west towards Perth. (BLD) With the option to start your holiday in Adelaide, board the Indian Pacific at Adelaide Parklands Rail Terminal.

Day 3: Monday or Friday

The Nullarbor, Cook and Kalgoorlie: Stop at one of the world's most remote outposts, Cook. Stretch your legs, and then it's on to Kalgoorlie, where you can join an Off Train Excursion. (BLD)

Day 4: Tuesday or Saturday

Perth: Arrive in Perth this morning and transfer to your accommodation for the next three nights at Travelodge Perth Hotel. (B)

Day 5: Wednesday or Sunday

Swan River and Fremantle: Enjoy a full day discovering Perth's major tourist attractions on an open top double decker bus. Cruise along the Swan River to Fremantle. Enjoy a scenic tour aboard a replica tram before some free time to explore at your own pace. (B)

Day 6: Thursday or Monday

Perth: With so much to see and do in and around this great city, you'll be glad you have one more day left up your sleeve. (B)

Day 7: Friday or Tuesday

Perth: Enjoy breakfast at the hotel before checking out. (B)

Reverse Itinerary: Perth departs on Sunday or Thursday.

Alternative Departure: Adelaide departs on Sunday or Thursday.

Booking Code: 4SP/AP

7 Days 6 Nights

Includes

- Three nights on board the Indian Pacific, Gold Service private cabin.
- Station to hotel transfer in Perth with a city sights introduction.
- Three nights accommodation in Perth.
- Tour of Perth, Swan River Cruise and tour of the Port of Fremantle by replica tram.
- All meals as specified in your itinerary: (B) breakfast, (L) lunch, (D) dinner.

Fares

Total package per person twin share from (\$)

Sydney to Perth or v.v.

Days	7
Adult pp	\$2993
Adult single	\$3100
Pen/CSHC pp	\$2246
Pen/CSHC single	\$2430

Adelaide to Perth or v.v.

Days	6
Adult pp	\$2303
Adult single	\$2460
Pen/CSHC pp	\$1740
Pen/CSHC single	\$1961

Perth and Margaret River

Perth, Fremantle and Margaret River Wine Region

Day 1: Saturday or Wednesday

Indian Pacific: Join the mighty Indian Pacific in Sydney. (D)

Day 2: Sunday or Thursday

Broken Hill and Adelaide: Explore Broken Hill on an Off Train Excursion before reboarding the Indian Pacific. In Adelaide there's time for another Off Train Excursion before heading west towards Perth. (BLD)

Day 3: Monday or Friday

The Nullarbor, Cook and Kalgoorlie: Stop at one of the world's most remote outposts, Cook. Stretch your legs, and then it's on to Kalgoorlie, where you can join an Off Train Excursion. (BLD)

Day 4: Tuesday or Saturday

Perth: When you arrive in Perth you are transferred to Miss Maud Swedish Hotel, your base for the next two nights. (B)

Day 5: Wednesday or Sunday

Perth and Fremantle: Enjoy a city sights tour that includes the historic Port of Fremantle and a cruise on the Swan River. (B)

Day 6: Thursday or Monday

Perth to Margaret River: Travel to Busselton and marvel at the 2km long jetty. Continue south to Margaret River wine region. Head to Mammoth Cave and Cape Leeuwin Lighthouse. (BLD)

Day 7: Friday or Tuesday

Margaret River to Perth: This morning is at leisure. See behind the scenes, visit The Chocolate Factory, Cheese Factory and a local boutique brewery. Overnight, Miss Maud Swedish Hotel. (BL)

Day 8: Saturday or Wednesday

Perth: Enjoy breakfast at the hotel before checking out. (B)

Alternative Departure: Adelaide departs on Sunday or Thursday.

Booking Code: 55SP/AP

8 Days 7 Nights

Includes

- Three nights on board the Indian Pacific, Gold Service private cabin.
- Three nights accommodation in Perth.
- Half day tour of Perth and the Port of Fremantle plus a Swan River Cruise.
- Two day tour of the Margaret River region with one nights accommodation, most meals and sightseeing.
- All meals as specified in your itinerary: (B) breakfast, (L) lunch, (D) dinner.

Fares

Total package per person twin share from (\$)

Sydney to Perth

Days	8
Adult pp	\$3686
Adult single	\$3822
Pen/CSHC pp	\$2896
Pen/CSHC single	\$3102

Adelaide to Perth

Days	7
Adult pp	\$2996
Adult single	\$3182
Pen/CSHC pp	\$2390
Pen/CSHC single	\$2633



River and Rail

8 Days 7 Nights

Adelaide and the Murray River

Day 1: Wednesday

Indian Pacific: Join the mighty Indian Pacific in Sydney. Settle in to your private cabin or meet your fellow travellers in the Outback Explorer Lounge. (D)

Day 2: Thursday

Broken Hill and Adelaide: Explore Broken Hill on an Off Train Excursion before reboarding the Indian Pacific to Adelaide. On arrival in Adelaide, transfer to the Hotel Grand Chancellor Adelaide on Hindley. (BL)

Day 3: Friday

Adelaide and Mannum: This morning is yours at leisure. Mid afternoon transfer to Mannum, the birthplace of the Murray River trade and communication, for your cruise aboard the PS Murray Princess. Enjoy pre-dinner drinks and a welcome dinner. As you cruise under floodlight to your overnight mooring at Mundarra, you may see nocturnal wildlife on the riverbank. (BD)

Day 4: Saturday

Murray Bridge and Craignook: In 1879 the first bridge to span the Murray River was built at Edwards Crossing, which quickly became the bustling township of Murray Bridge. After a hearty breakfast, join a guided tour of the historic landmarks and local attractions of Murray Bridge. This afternoon begin your journey upriver. Tonight moor at Craignook, where after dinner you can enjoy being entertained by the talented crew. (BLD)

Day 5: Sunday

River View Lodge: All ashore for a guided nature walk where your guide will share the secrets of the local flora and fauna. It's a great way to get in a little exercise before PS Murray Princess departs for the big river gorges and 90 metre cliffs of the upper river. In the afternoon, head downriver to River View Lodge where your discovery vessel awaits for a backwater wildlife tour. Travelling in small, personalised groups explore the maze of the river and the amazing birdlife. This evening join the Captain and Officers for pre-dinner drinks and the finale Captain's Dinner and Dance. (BLD)

Day 6: Monday

Mannum and Adelaide: After breakfast, PS Murray Princess arrives at Mannum where you reluctantly say farewell before transferring back to Adelaide and the Hotel Grand Chancellor Adelaide on Hindley. (B)

Day 7: Tuesday

Adelaide: Today is free to enjoy at leisure. Why not visit the seaside suburb of Glenelg, shop in Rundle Mall or simply relax in the comfort of your hotel. (B)

Day 8: Wednesday

Adelaide: Enjoy breakfast at the hotel before checking out. (B)

Alternative Departure: Perth departs on Thursday.

Booking Code: 52SA11/AP11

Includes

- One night on board the Indian Pacific, Gold Service private cabin.
- Three nights accommodation in Adelaide.
- Three night cruise on the PS Murray Princess including all meals, accommodation (outside cabin), on-board spas, saunas and exercise deck. Guided nature walks, Aboriginal cultural tour, Captain's Dinner and onboard entertainment.
- All meals as specified in your itinerary: (B) breakfast, (L) lunch, (D) dinner.

Fares

Total package per person twin share from (\$)

Sydney to Adelaide

Days	8
Adult pp	\$2389
Adult single	\$2825
Pen/CSHC pp	\$2225
Pen/CSHC single	\$2671

Adelaide to Perth

Days	10
Adult pp	\$3412
Adult single	\$3812
Pen/CSHC pp	\$2849
Pen/CSHC single	\$3313

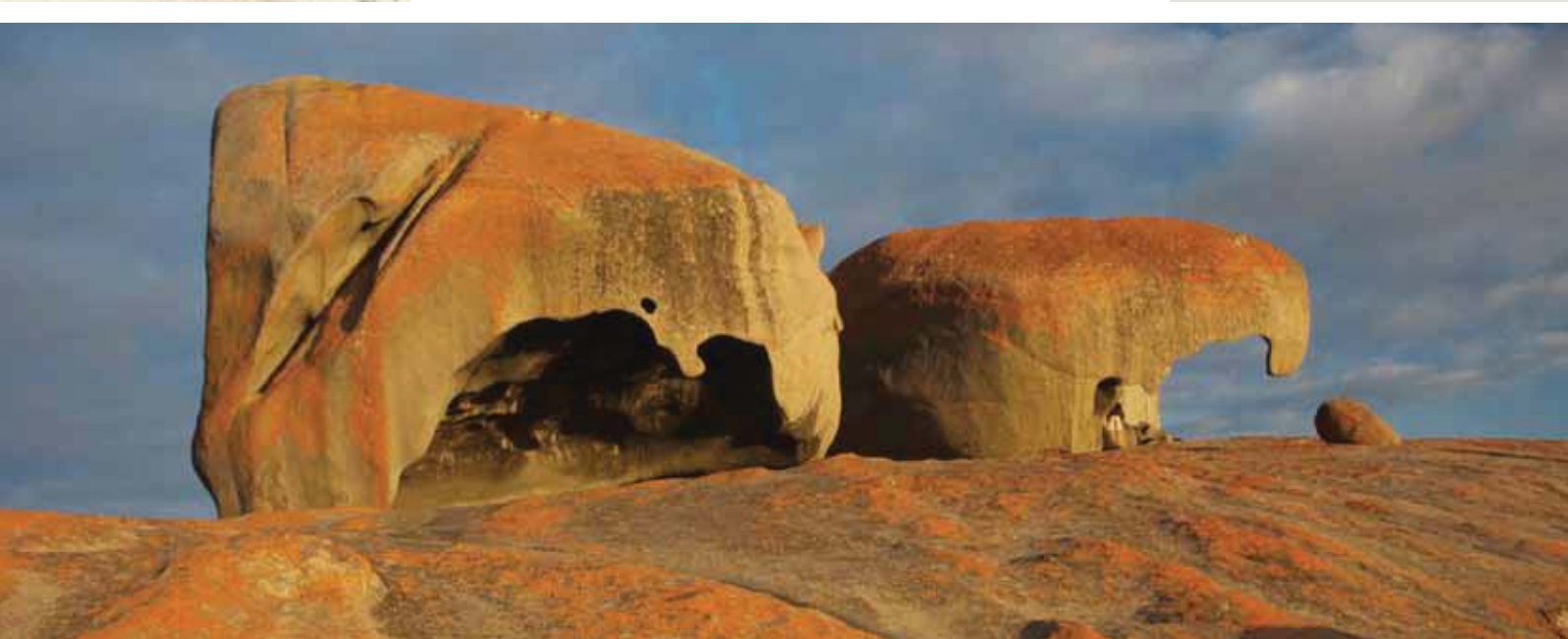

Exceptional Kangaroo Island

6 Days 5 Nights

Adelaide and Kangaroo Island

Day 1: Saturday or Wednesday

Indian Pacific: Join the mighty Indian Pacific in Sydney. Settle in to the comforts of this great train, enjoy a drink in the Outback Explorer Lounge and meet your fellow travellers as you journey overnight. (D)

Day 2: Sunday or Thursday

Broken Hill and Adelaide: Explore Broken Hill on an Off Train Excursion before reboarding the Indian Pacific for the remainder of your journey to Adelaide. Transfer to Crowne Plaza Adelaide, your base for the next two nights. (BL)

Day 3: Monday or Friday

Adelaide: Today is free for you to enjoy Adelaide at leisure. Take in a spot of shopping in Rundle Mall, visit the seaside suburb of Glenelg aboard the tram or simply relax in the comfort of your accommodation – the choice is yours. (B)

Day 4: Tuesday or Saturday

Kangaroo Island: Make your way to Adelaide Airport this morning for your flight to Kangaroo Island where on arrival you will be met by your guide. Your full day tour blends a range of wildlife experiences with an elegant barbecue. Take in a variety of landscapes from Cygnet River valley through to the north coast. Get an introduction to Island life, where things take time. Walk down a country track through tall Eucalyptus trees where koalas snooze overhead. Visit Seal Bay Conservation Park and take in many other sights. (BLD)

Day 5: Wednesday or Sunday

Kangaroo Island: Today explore some of Kangaroo Island's highlights and lesser known backtracks of Flinders Chase National Park, unspoilt and diverse, it is home to a wide array of wildlife species such as kangaroos, wallabies, possums, goannas, echidnas, koalas, platypus and many birds. The drive down to Cape du Couedic takes in some dramatic dune country with a complex fire history and an interesting range of vegetation types. Visit a fur seal colony; these animals can be observed at rest on the rocks or frolicking in the surf under Admirals Arch – a spectacular coastal grotto. See Remarkable Rocks, huge natural granite sculptures which have been carved by relentless winds, rain and salt from the Southern Ocean. Return to Adelaide by air and to your overnight accommodation at Crowne Plaza Adelaide. (BL)

Day 6: Thursday or Monday

Adelaide: Enjoy breakfast at the hotel before checking out. (B)

Reverse Itinerary: Adelaide departs on Monday or Friday.

Alternative Departure: Perth departs on Wednesday or Sunday.

Booking Code: 54SA/PA

Includes

- One night on board the Indian Pacific, Gold Service private cabin.
- Three nights accommodation in Adelaide.
- Two day Kangaroo Island in Style tour including personalised touring, dinner, bed and breakfast accommodation, return airfare from Adelaide and airport transfers on the Island.
- All meals as specified in your itinerary: (B) breakfast, (L) lunch, (D) dinner.

Fares

Total package per person twin share from (\$)

Sydney to Adelaide or v.v.

Days	6
Adult pp	\$2843
Adult single	\$3083
Pen/CSHC pp	\$2679
Pen/CSHC single	\$2929

Perth to Adelaide or v.v.

Days	7
Adult pp	\$3773
Adult single	\$3903
Pen/CSHC pp	\$3210
Pen/CSHC single	\$3404

Discover Rottneest and Wave Rock

7 Days 6 Nights



Perth, Rottneest Island and Wave Rock

Day 1: Wednesday

Perth: Make your own way to Perth and check in to Travelodge Perth, your base for the next four nights.

Day 2: Thursday

Rottneest Island: Departing from Perth, take a leisurely cruise down the Swan River to Fremantle where you board a high speed ferry to Rottneest Island. Join a coach tour around the Island to view some of Rottneest's most spectacular locations, cultural and historical heritage and diverse wildlife. Enjoy lunch followed by free time for a swim or walk. You may even meet a friendly quokka. (BL)

Day 3: Friday

Wave Rock, York, Wildflowers and Aboriginal Culture: Head east through the scenic Darling Ranges to York, the first township founded in the Avon Valley. Visit the Dog Cemetery before arriving in Hyden to see Hippo's Yawn, a rock formation which resembles a hippo yawning. Enjoy a buffet lunch at the Wildflower Shop. See the spectacle of Wave Rock and the ancient Gnamma Holes. Leaving Wave Rock, visit The Humps and Mulka's Cave. Return to Perth via the quaint country town of Babakin. (BL)

Day 4: Saturday

Perth: Today is free for you to enjoy at your own pace. Take an optional tour, visit the city's many attractions or simply relax in the comfort of your accommodation. (B)

Day 5: Sunday

Indian Pacific: Board the Indian Pacific and settle in to your private cabin. Meet your fellow travellers in the Outback Explorer Lounge as you travel east to Kalgoorlie where you can join an Off Train Excursion. Reboard the train and continue your journey east overnight. (BLD)

Day 6: Monday

The Nullarbor and Cook: Today travel across the desolate Nullarbor Plain stopping at one of the world's most isolated outposts, Cook. Sit back, relax and enjoy the hospitality onboard as you dine in the Queen Adelaide Restaurant and delight in the views of the passing scenery. (BLD)

Day 7: Tuesday

Adelaide: Your holiday concludes on arrival in Adelaide. (B)

Reverse Itinerary: Sydney departs on Saturday or Wednesday. Adelaide departs on Sunday or Thursday.

Booking Code: 11PA/PS

Includes

- Two nights on board the Indian Pacific, Gold Service private cabin.
- Four nights accommodation in Perth.
- Touring of Rottneest Island including return ferry transfers.
- Wave Rock, York, Wildflowers and Aboriginal Culture tour.
- All meals as specified in your itinerary: (B) breakfast, (L) lunch, (D) dinner.

Fares

Total package per person twin share from (\$)

Perth to Adelaide or v.v.

Days	7
Adult pp	\$2731
Adult single	\$2983
Pen/CSHC pp	\$2142
Pen/CSHC single	\$2458

Perth to Sydney or v.v.

Days	8
Adult pp	\$3421
Adult single	\$3623
Pen/CSHC pp	\$2648
Pen/CSHC single	\$2927



Spectacular South West Wonders

13 Days 12 Nights

Margaret River, Albany, Esperance, Kalgoorlie, Wave Rock, Fremantle and Perth

Day 1: Thursday

Indian Pacific: Board the Indian Pacific in Adelaide. Settle in, relax and meet your fellow travellers.

Day 2: Friday

The Nullarbor, Cook and Kalgoorlie: Stop at Cook, where there's time to stroll around before travelling west to Kalgoorlie. (BLD)

Day 3: Saturday

Perth: Arrive in Perth. Join a city tour before enjoying a welcome drink and dinner. (BD)

Day 4: Sunday

Perth and Margaret River: Travel south through Busselton, and on to Mammoth Cave, home to ancient fossil remains. Continue to Margaret River, your base for the next two nights. (BD)

Day 5: Monday

Margaret River: Enjoy a scenic journey through the Leeuwin-Naturaliste National Park and see Cape Leeuwin Lighthouse. Later join a tour including tastings and delicious lunch at Palandri Winery. (BL)

Day 6: Tuesday

Margaret River and Albany: View the Gloucester Tree and journey through the Valley of the Giants. Continue to the Natural Bridge and The Gap, then visit Whaleworld. Overnight Albany. (BD)

Day 7: Wednesday

Albany and Esperance: Visit the Anzac Memorial and travel to Bluff Knoll Lookout to witness the Stirling Ranges. Continue to Esperance and the Pink Lake. Overnight Esperance. (BD)

Day 8: Thursday

Cape Le Grand and Kalgoorlie: Travel into Cape Le Grand National Park for coastal views and north to the historic gold mining township of Kalgoorlie, your base for the next two nights. (BD)

Day 9: Friday

Kalgoorlie: Try panning for gold, witness gold bullion being poured and go underground for a tour of the Mining Reserve. This afternoon explore this gold town at leisure. (B)

Day 10: Saturday

Wave Rock: Journey to Wave Rock a striking rock formation, resembling a gigantic wave. Continue to York before travelling on to Fremantle. Overnight Fremantle. (BD)

Day 11: Sunday

Fremantle and Perth: Explore Fremantle at leisure before joining a cruise along the Swan River to Perth. Stay at Miss Maud Swedish Hotel, your base for the next two nights. (B)

Day 12: Monday

Perth: Today is free for you to enjoy at leisure. (B)

Day 13: Tuesday

Perth: Check out of your hotel this morning. (B)

Alternative Departure: Sydney departs on Wednesday.

Booking Code: 18AP11/SP11

Includes

- Two nights on board the Indian Pacific, Gold Service private cabin.
- Two nights accommodation in Perth.
- Nine day tour of Margaret River, Albany, Valley of the Giants, Esperance, Kalgoorlie, Wave Rock, Fremantle and Perth including accommodation, sightseeing and most meals.
- All meals as specified in your itinerary: (B) breakfast, (L) lunch, (D) dinner.

Fares

Total package per person twin share from (\$)

Adelaide to Perth - Gold Service

Days	13
Adult pp	\$4862
Adult single	\$5523
Pen/CSHC pp	\$4254
Pen/CSHC single	\$4979

Sydney to Perth - Gold Service

Days	14
Adult pp	\$5552
Adult single	\$6163
Pen/CSHC pp	\$4760
Pen/CSHC single	\$5448

Adelaide to Perth - Platinum Service

Days	13
Adult pp	\$6012
Adult single	\$9180
Pen/CSHC pp	\$5967
Pen/CSHC single	\$9135

Sydney to Perth - Platinum Service

Days	14
Adult pp	\$7062
Adult single	\$11018
Pen/CSHC pp	\$7017
Pen/CSHC single	\$10973

Set departures available.

Ex Adelaide: 17 April; 15 May; 12 June; 10 July; 07, 21 & 28 August; 04, 11, 18 & 25 September; 02, 16 & 30 October; 27 November; 25 December 2014; 08 January; 05 February; 05 March 2015.



Darwin

Tours and Accommodation

Darwin not only holds its own delights, it is also your gateway to the many wonders of the Top End. In addition to the markets, galleries, museums, nightlife and delicious harbourside dining, you'll find yourself within easy reach of natural wonderlands like Litchfield National Park, Kakadu, Arnhem Land, Cobourg Peninsula and the Tiwi Islands. While you could easily lose yourself exploring cosmopolitan attractions of the city of

Darwin itself, it's these wilderness areas that really make this part of the world like nothing on Earth. The wildlife, history and landscapes are all completely unique and can vary dramatically between regions. Aboriginal rock art, cascading waterfalls, magnificent rock formations, glorious rivers for fishing or spotting the prehistoric saltwater crocodiles are all so accessible from the moment you hop off The Ghan.



Average Temperatures (Celsius)

December - February	25° - 32°
March - May	24° - 32°
June - August	20° - 31°
September - November	24° - 33°





Darwin City Sights

Hop on and explore the sights of Darwin on this fun and unique open-air tour bus.

Hop on and off the Tour Tub, a fun open-air bus that operates an hourly route around Darwin city. Sit back, relax, and enjoy Darwin's tropical atmosphere as your friendly guide provides informative commentary about this vibrant city and its rich history.

Visit Darwin's 10 major attractions including stops at the Indo Pacific Marine, the Australian Pearling Exhibition, the George Brown Darwin Botanic Gardens, Aquascene Fish Feeding, East Point Military Museum, Art Gallery, Fannie Bay Gaol, World War II Oil Storage Tunnels and more. Hop on and off the bus at any of the scheduled stops to further explore all the delights that Darwin has to offer.

Day Pass

Cost: \$45pp (adult)
\$40pp (pension)

Includes: Touring, entry to WWII Oil Storage Tunnels, discounts to attractions and commentary (not included: admission costs to attractions)

Departs: Darwin, daily 9.00am to 4.00pm (Apr-Sep)

Returns: Hourly

Booking Code: TT01



Charles Darwin Sunset Buffet Dinner Cruise

Enjoy a delicious Territory Style Buffet as you cruise in to the Darwin sunset aboard 'Charles Darwin'.

A unique tropical dining experience aboard the Captains Deck (main deck) of the 'Charles Darwin'. This cruise is a great way to get a bird's eye view of the famous Darwin sunset whilst enjoying a delicious Territory Style Buffet with Australian seafood and local produce all in air-conditioned comfort. This two and a half hour cruise also includes great commentary and offers the best value for money dinner cruise on Darwin Harbour. The 'Charles Darwin' is the perfect way to have dinner and enjoy the scenery at the same time, a sight not to be missed.

2.5 Hours

Cost: \$89pp (adult/pension)

Includes: Territory Style Buffet meal, cruising (not included: transfers)

Departs: Darwin (Stokes Hill Wharf), daily at 5.45pm (except 25 Dec & 01 Jan)

Returns: 8.30pm

Booking Code: DHCCDB



Afternoon City Sights Tour

The perfect introduction to Darwin is a relaxing afternoon city sights tour.

Join an afternoon city sights tour for a comprehensive and interesting tour of Darwin with expert commentary by an experienced and knowledgeable guide. Pick up from your Darwin accommodation and travel in an air-conditioned coach as you explore the rich historical and cultural sights the city has to offer. See the Chinese Temple and lush Botanic Gardens. Tour the historic sites of the city including the East Point Military Precinct. See the Stokes Hill Wharf area and the Mooring Basin. There is also time to explore the Museum and Art Gallery of the Northern Territory, whose collections encompass Aboriginal art, visual arts and Northern Territory history and natural sciences.

4 Hours

Cost: \$75pp (adult)
\$68pp (pension)

Includes: Touring, return transfers

Departs: Darwin, daily at 2.00pm (except 25, 26 Dec & 01 Jan)

Returns: 6.00pm

Booking Code: D-2



Frontline Australia WWII Journey

Set foot on sites that were hit by the largest attacks ever made against Australia during World War II.

On 19 February 1942, Darwin came under attack by air raids mounted by the Japanese. These attacks were the largest to ever be experienced by Australia and the sites hit by these attacks still hold deep significance in Australian history. On this half day tour, learn about the bombing of Darwin during WWII, see historic relics, view an anti-aircraft gun site and explore Darwin's Military Museum. Head out to cruise Darwin Harbour and view the modern day Navy Base, HMAS Coonawarra. Visit the Catalina Flying Boat Base and discover historic bunkers and ammunition storages in Charles Darwin National Park. Admire the views of Darwin Harbour from the lookout platform.

4 Hours

Cost: \$109pp (adult)
\$98pp (pension)

Includes: Entry fees, touring, cruise, return transfers

Departs: Darwin, daily at 8.00am

Returns: 12.00pm

Booking Code: DW-2



Bombing of Darwin WWII Heritage Tour

4 Hours

Learn about one of the most historical events in Australian history: the bombing of Darwin.

Darwin was devastated and Australia threatened by the Japanese bombings in World War II. Many questions still surround the event today: Why was the truth concealed? What really did happen? Find out the answers to these fascinating questions, plus much more on this unique personalised tour. You will see visible reminders of the bombings of World War II as well as Darwin's beautiful sights at the same time. Visit the Catalina Flying Boat Base, the Submarine Boom Cable, the anti-aircraft gun site and many more places that give Darwin its rich history. You will hear accurately researched and entertaining commentary throughout the tour aboard fully air-conditioned, comfortable transport. Entry to Museum is included.

Cost: \$90pp (adult/pension)
Includes: Entry fees, touring, return transfers
Departs: Darwin, daily at 8.30am (May-Oct)
Returns: 12.30pm
Booking Code: BOMB



Jumping Crocodiles Cruise

6 Hours

Get up close and personal to Darwin's jumping crocodiles!

Now this is something you don't see every day – jumping crocodiles. But make no mistake, this is no wildlife park attraction, this is a one hour cruise down Adelaide River that is like no other. These are real crocodiles in the wild, the closest living animals to the dinosaurs, and your local guide will entice them to leap out of the water just so they can have a bite to eat. Continue to the Window on the Wetlands Visitor Centre and enjoy superb views across the Murrumbidgee Plains from the highest point on the lower Adelaide River floodplain. Make a stop at Fogg Dam Conservation Reserve to experience its diverse habitat and wildlife.

Cost: \$105pp (adult)
\$95pp (pension)
Includes: Touring, return transfers, cruise
Departs: Darwin, daily at 12.45pm (except 25, 26 Dec & 01 Jan)
Returns: 6.30pm
Booking Code: 07



Litchfield National Park

1 Day

Escape the hustle and bustle of city life and venture deep into monsoon forests and open woodland.

They say good things come in threes, which couldn't be more true for this waterfall wonderland located less than two hours from Darwin. First stop is Florence Falls, where you have the opportunity to take a scenic and interpretive bush and monsoon vine forest walk. There is also the chance for a swim by making your way down the stairs to the plunge pool below. Lay back and soak up the tropical sunshine during a picnic lunch. Travel on to Tolmer Falls for a magnificent view of the water cascading down to the deep waterhole at the base of the falls. Finally, visit Wangi Falls, with its large crystal clear pool, another relaxing spot for a swim. This is a great day for taking many fascinating photos, including the amazing stand of termite mounds.

Cost: \$159pp (adult)
\$143pp (pension)
Includes: Touring, lunch, return transfers
Departs: Darwin, daily at 7.30am (except 25 Dec & 01 Jan)
Returns: 6.00pm
Fitness: Good level of fitness required
Booking Code: D5



Kakadu, Nourlangie Rock & Yellow Water

1 Day

Discover the wonder of Kakadu with this perfect mix of scenery, culture, relaxation and adventure.

Leave the city behind for a day and venture down the Arnhem Highway across the Adelaide River. As you travel through the Murrumbidgee Plains in a luxury coach, take notice of the wide array of native wildlife that have made this region their home. For those who prefer the air, take a scenic flight at an additional cost. The first stop is Nourlangie Rock, where your experienced driver and guide will lead you on a walk to view Aboriginal rock art that is centuries old. Set off on a cruise of the Yellow Water Billabong. Don't forget to look out for saltwater crocodiles and the colourful birdlife of the region. Visit the Warradjan Aboriginal Cultural Centre to learn more about the history of the Aboriginal people of Kakadu, before heading back to Darwin.

Cost: \$235pp (adult)
\$212pp (pension)
Includes: Touring, cruise, return transfers (not included: dinner)
Departs: Darwin, daily at 6.30am (except 25 Dec & 01 Jan)
Returns: 7.30pm
Fitness: Good level of fitness required
Booking Code: D4



Palms City Resort



64 The Esplanade, Darwin

Located on the Esplanade, overlooking the fascinating Darwin Harbour and parkland foreshores, this resort style accommodation offers beautifully landscaped gardens that create a tropical paradise in the heart of the city. Only a stroll to the city's restaurants, night markets and entertainment district, everything you need is in the palm of your hand. For total relaxation, start every day with a refreshing swim in the free-form swimming pool before enjoying complimentary breakfast in the restaurant.

Amenities include: 24 hour reception, restaurant, wireless internet, swimming pool, car parking, guest laundry, air-conditioning, ceiling fans.

Per person, per night, room only (\$)

MOTEL ROOM	Twin	Single	Triple
April - September	115.00	230.00	97.70
October - March	80.00	160.00	74.40
SUPERIOR ROOM	Twin	Single	Triple
April - September	122.50	245.00	102.70
October - March	85.00	170.00	77.70

Bonus: Includes complimentary breakfast daily.

Booking Code: PALMS



Travelodge Mirambeena Resort Darwin



64 Cavenagh Street, Darwin

The Travelodge Mirambeena Resort has a unique tropical feel, ample space to relax and is located in the heart of Darwin's central business district. Featuring two resort-style pools with waterfalls and spas this inner city oasis is the perfect retreat for those looking for relaxation and rejuvenation. The resort is located close to 'everything' this tropical city has to offer.

Amenities include: Restaurant, café, bar, room service, swimming pools, spas, fitness room, car parking, laundry service, air-conditioning.

Per person, per night, room only (\$)

GUEST ROOM	Twin	Single	Triple
April	71.50	143.00	65.70
May - October	143.00	286.00	113.40
November - March	71.50	143.00	65.70

Booking Code: MIRAMB



DoubleTree by Hilton Darwin



122 The Esplanade, Darwin

Experience the friendliness of the Top End at DoubleTree by Hilton Darwin. Located on the Esplanade with panoramic views over the Darwin Harbour where the Arafura Sea stretches out before you. Those who rise early for day tours can enjoy breakfast in the poolside restaurant, which overlooks the pool and surrounding gardens. Stroll along the waterfront parkland, or walk in to town for business or shopping.

Amenities include: Restaurant, bar, room service, swimming pool, internet, car parking, guest laundry, air-conditioning.

Per person, per night, room only (\$)

GUEST ROOM	Twin	Single	Triple
April (Mon-Thu)	114.00	228.00	98.40
April (Fri-Sun)	79.00	158.00	75.00
May - Oct (Mon-Thu)	203.50	407.00	158.00
May - Oct (Fri-Sun)	114.00	228.00	98.40
Nov - Mar (Mon-Thu)	114.00	228.00	98.40
Nov - Mar (Fri-Sun)	79.00	158.00	75.00

Booking Code: HOLDRW



Mantra On The Esplanade



88 The Esplanade, Darwin

Situated on Darwin's picturesque Esplanade, the Mantra On The Esplanade boasts panoramic views of Darwin Harbour to the Arafura Sea. This award-winning hotel offers a selection of hotel rooms or one, two and three bedroom apartments all designed with the ambience and style of the tropical, laid-back atmosphere. Apartments have large private balconies, perfect for experiencing a famous Northern Territory sunset.

Amenities include: 24 hour reception, restaurant and bar, internet access, room service, pool, spa, beautician, air-conditioning.

Per person, per night, room only (\$)

CITY VIEW	Twin	Single	Triple
April	129.50	259.00	N/A
May - September	169.50	339.00	N/A
October	129.50	259.00	N/A
November - March	89.50	179.00	N/A
HARBOUR VIEW	Twin	Single	Triple
April	139.50	279.00	N/A
May - September	179.50	359.00	N/A
October	139.50	279.00	N/A
November - March	99.50	199.00	N/A

Booking Code: SAVDRW



Darwin Accommodation



DoubleTree by Hilton Esplanade Darwin



The Esplanade, Darwin

Relaxation is an art form in Darwin and at DoubleTree by Hilton Esplanade Darwin this is complemented by a touch of tropical elegance and efficient, friendly guest service. The hotel is perfectly positioned on Darwin's Esplanade, and boasts stunning parkland with ocean views and the bustle of Darwin's most vibrant location, Mitchell Street. The hotel is located in the central business district, and is only a leisurely 5 minute walk to the heart of the city's shopping and restaurant precinct.

Amenities include: Restaurant, bar, internet access, room service, hair/beauty salon, swimming pool, car parking, air-conditioning.

Per person, per night, room only (\$)

GUEST ROOM	Twin	Single	Triple
April (Mon-Thu)	111.00	222.00	96.40
April (Fri-Sun)	75.50	151.00	72.70
May - Oct (Mon-Thu)	200.00	400.00	155.70
May - Oct (Fri-Sun)	111.00	222.00	96.40
Nov - Mar (Mon-Thu)	111.00	222.00	96.40
Nov - Mar (Fri-Sun)	75.50	151.00	72.70

Booking Code: HOLESP



Darwin Central Hotel



21 Knuckey Street, Darwin

Located in the heart of the city, Darwin Central Hotel is locally owned, managed and staffed by a friendly, professional team and is within easy walking distance to all major banks, cinemas, theatres, nightclubs, restaurants and shopping. The hotel features beautifully appointed rooms furnished with state of the art décor to create a modern, cool and relaxing ambience, where guests can relax in comfort and style.

Amenities include: Restaurant, bar, internet access, coffee shop, room service, swimming pool, laundry service, air-conditioning.

Per person, per night, room only (\$)

TWIN QUEEN	Twin	Single	Triple
April	97.00	194.00	91.40
May - August	143.50	287.00	122.40
September - March	97.00	194.00	91.40

Bonus: Stay 4 consecutive nights and pay for only 3 or stay 7 consecutive nights and pay for only 5 during Nov-Mar.

Note: Upgrade to King Deluxe room available at additional cost.

Booking Code: CENDRW



Hilton Darwin



32 Mitchell Street, Darwin

Hilton Darwin is located in the centre of Darwin's lively café strip, with easy access to the city's many restaurants, shopping and entertainment districts. The majestic foyer offers superior service in luxurious surrounds, complemented by excellent hotel facilities and friendly attentive staff. Your room features local art while many have stunning views of Darwin Harbour. Sample distinctive Darwin Cuisine at Redsalt Restaurant or relax in the 10th floor outdoor pool.

Amenities include: Restaurant, internet access, cocktail lounge, beauty salon, swimming pool, fitness centre, car parking, air-conditioning.

Bonus: Stay 4 consecutive nights and pay for only 3 during Apr, Oct, Nov and Feb-Mar.

Per person, per night, room only (\$)

GUEST ROOM	Twin	Single	Triple
April (Mon-Thu)	129.00	258.00	112.70
April (Fri-Sun)	93.00	186.00	88.70
May - Oct (Mon-Thu)	218.00	436.00	172.00
May - Oct (Fri-Sun)	129.00	258.00	112.70
Nov - Mar (Mon-Thu)	129.00	258.00	112.70
Nov - Mar (Fri-Sun)	93.00	186.00	88.70

Booking Code: CRODRW



SKYCITY Darwin



Gilruth Avenue, The Gardens, Darwin

Nestled on Mindil Beach, SKYCITY is Darwin's only 5 star beachside resort. This elegant hotel offers boutique-style accommodation that sets a standard of contemporary luxury in Darwin. The property redefines Top End luxury tourism with its a-la-carte restaurant, terrace bar and swim-up bar. It is surrounded by tropical gardens with sweeping ocean views and is a great location to view Darwin's famous summer lightning storms and sunsets.

Amenities include: Restaurants and cocktail lounge, bars, wireless internet, sauna, swimming pool, fitness centre, tennis, complimentary golf fees, casino gaming, laundry, air-conditioning.

Bonus: Stay 4 consecutive nights and pay for only 3 or stay 7 consecutive nights and pay for only 5 in a Deluxe Room during Nov-Mar.

Per person, per night, room only (\$)

DELUXE ROOM	Twin	Single	Triple
April	95.00	190.00	92.40
May - October	132.00	264.00	117.00
November - March	95.00	190.00	92.40

SUPERIOR SPA ROOM	Twin	Single	Triple
April	120.00	240.00	109.00
May - October	157.50	315.00	134.00
November - March	120.00	240.00	109.00

Note: Upgrade to Ocean View available at additional cost.

Booking Code: SKYCITY

Alice Springs and Uluru

Tours and Accommodation

The town of Alice Springs holds such character and charm; it's the perfect introduction to Australia's Red Centre, the fiery heart of our great land. Alice Springs offers amazing glimpses into Outback life, but it's when you venture out of town you discover some of the area's best hidden treasures. From watching changing colours of the sunset over the

world-famous Uluru (Ayers Rock), to the East and West MacDonnell Ranges, Kings Canyon and Kata Tjuta, our tailored touring options give you the chance to make your holiday one of adventure and exploration. From luxury to budget, coach and 4WD to helicopter and even hot air balloon, you'll leave with lasting memories of this enchanting region.

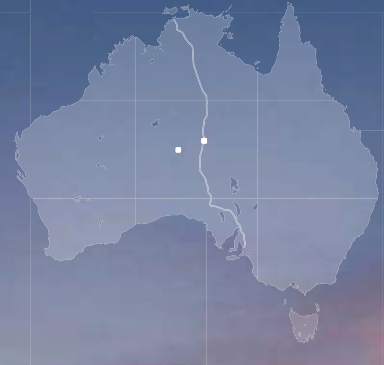

Average Temperatures (Celsius)

December - February	21° - 36°
March - May	13° - 28°
June - August	5° - 21°
September - November	14° - 31°

THE GHAN





Alice Springs Tours



Balloon Flight

Experience the breathtaking feeling of floating silently above the Outback as the sun slowly rises over the desert on this awe-inspiring ballooning adventure.

Journey to the launch site in the cool pre-dawn darkness, and begin your ascent just as the morning light begins to illuminate the rugged MacDonnell Ranges. Float gently across the vast expanse of the Australian Outback, keeping an eye out for native wildlife including the iconic Red Kangaroo, and gain an appreciation of the remoteness of the area as you glide across the landscape. After landing you may become involved in assisting the crew as we pack the balloon into its bag. At the balloon landing site you will be offered champagne accompanied by refreshments.

30 Minutes

Cost: \$265pp (adult/pension)
Includes: Balloon flight, flight certificate, refreshments, return transfers (not included: \$25 insurance fee, payable direct)
Departs: Alice Springs, daily between 4.00am - 5.00am (except 25, 26 Dec & 01 Jan)
Returns: Between 8.30am-9.30am
Booking Code: OBB30



A Town Like Alice

Affectionately known as 'The Alice', discover why this is the Red Centre's hidden treasure.

See the sights of 'The Alice' on this comprehensive and informative tour. Drop into the School of the Air which provides an educational service for children living in remote areas. Stop at the Alice Springs Telegraph Station, an historical reserve that marks the original site of the first European settlement in Alice Springs. The site features the original buildings of stone which have been restored over the years. Visit the Royal Flying Doctor Service and learn how this marvellous facility operates to provide a 'mantle of safety' to the people of the Outback. Later, visit the Alice Springs Reptile Centre where you can see unique Central Australian reptiles. Conclude with a panoramic view of Alice Springs from the top of ANZAC Hill.

4 Hours

Cost: \$95pp (adult)
\$86pp (pension)
Includes: Touring, entry fees, return transfers
Departs: Alice Springs, daily (Apr-Nov) Mon, Thu & Sat (Dec-Mar) at 2.00pm (except 25 Dec & 01 Jan)
Returns: 6.00pm
Booking Code: A3



Drovers Blowout Dinner

Dust off your boots and step into the Overlanders Steakhouse for a true taste of the Outback.

If you literally want a taste of Australia, dinner at the historic Overlanders Steakhouse is a must. The signature menu of the restaurant is the world famous 'Drovers Blowout'. The menu features soup of the day with freshly baked damper. This is followed by tastings of Camel, Crocodile, Emu and Kangaroo. Your main course is a choice of either a tender Rump Steak or the ever popular Barramundi Fish. And if you're not 'blown out' at this stage, you will have a choice of either Apple Pie or the famous Australian Pavlova for dessert, with tea or coffee. Architecturally designed, the restaurant genuinely captures the rustic ambience of Outback Australia with its décor featuring historic saddlery used by local Drovers or Cattlemen of yesteryear and today.

4 Hours

Cost: \$94pp (adult/pension)
Includes: Dinner, limited beverages (not included: return transfers)
Departs: Alice Springs, daily at 6.00pm
Returns: 10.00pm
Booking Code: DROVER



Palm Valley Safari by 4WD

Buckle up for a 4WD safari through the harsh Australian desert.

An exciting 4WD safari travelling through the rugged Central Australian landscape and down the bed of one of the oldest watercourses in the world, the Finke River, into Palm Valley. See spectacular rock formations, white sands and an oasis of rock pools and palm trees. Some plants, such as the Cycad and Livistonia Mariae are known world-wide as relic plants and are unique to Central Australia. Visit the rock formation known as the Amphitheatre. Enjoy a picnic lunch in the Finke Gorge National Park. Stop at Hermannsburg, an Aboriginal community and historic precinct which is renowned for its Aboriginal art collection and the works of Albert Namatjira. On the return journey, relax and enjoy watching the changing colours of the magnificent mountain ranges in the afternoon light.

1 Day

Cost: \$149pp (adult)
\$134pp (pension)
Includes: Touring, morning tea, lunch, entry fees, return transfers
Departs: Alice Springs, daily (Jun-Oct) Mon, Wed, Thu, Sat & Sun (Nov-May) at 7.30am (except 25 Dec & 01 Jan)
Returns: 6.00pm
Note: Good level of fitness required
Booking Code: A5



Aurora Alice Springs



11 Leichhardt Terrace, Alice Springs

This vibrant property is the only accommodation on the Todd Mall – the most centrally located accommodation in Alice Springs. The Todd Mall is the main shopping, restaurant and entertainment precinct. Enjoy great meals in the hotel's Red Ochre Grill Café and Restaurant and savour the contemporary and native cuisine it has to offer. The Aurora Alice Springs places you in the perfect position to explore both the town and the spectacular surrounding Outback regions.

Amenities include: Restaurant, room service, wireless internet, car parking, swimming pool, guest laundry, free in-house movies, air-conditioning.

Per person, per night, room only (\$)

STANDARD ROOM	Twin	Single	Triple
April - June	78.50	157.00	64.40
July - November	85.50	171.00	103.50
December - March	78.50	157.00	64.40

Note: Upgrade to Deluxe room available at additional cost.

Booking Code: AURORA



DoubleTree by Hilton Alice Springs



82 Barrett Drive, Alice Springs

Set amidst the MacDonnell Ranges, DoubleTree by Hilton Alice Springs provides the perfect setting in the centre of the Outback. Set on 4.5 hectares of native bush gardens and a 1.5km walk to the city centre, this resort-style hotel is the perfect base from which to begin your exploration of Alice Springs and its surrounds. Soak up the vibrant atmosphere with a drink on the outside decking of the Lobby Bar.

Amenities include: Restaurant, bar, internet access, room service, swimming pool, fitness centre, spa, sauna, tennis court, laundry service, car parking, air-conditioning.

Per person, per night, room only (\$)

GUEST ROOM	Twin	Single	Triple
April - March	79.00	158.00	77.70
GUEST ROOM VIEW	Twin	Single	Triple
April - March	92.00	184.00	86.40

Booking Code: CROASP



The Chifley Alice Springs Resort



34 Stott Terrace, Alice Springs

The Chifley Alice Springs Resort combines efficient and friendly Outback service with modern, comfortable facilities. Low-rise architecture and lush green lawns contribute to the relaxed atmosphere, situated on the banks of the Todd River with its magnificent River Red Gums. Enjoy full buffet breakfasts, a-la-carte lunches and contemporary cuisine dinners at the Barra on Todd Restaurant. The hotel is only a five minute walk from the towns bustling cultural, shopping and business centre.

Amenities include: Restaurant, room service, wireless internet, bar, guest laundry, swimming pool, car parking, air-conditioning.

Per person, per night, room only (\$)

SUPERIOR ROOM	Twin	Single	Triple
April - October	83.50	167.00	71.40
November - February	64.00	128.00	58.40
March	83.50	167.00	71.40
DELUXE RIVER GUM	Twin	Single	Triple
April - October	95.50	191.00	79.40
November - February	73.50	147.00	64.70
March	95.50	191.00	79.40

Booking Code: ASRESORT



Lasseters Hotel Casino



93 Barrett Drive, Alice Springs

Lasseters Hotel Casino offers spacious rooms nestled beneath the famous MacDonnell Ranges. The centre of entertainment, there is always something happening at the hotel. Relax by the pool, play a game of tennis or use one of the complimentary bicycles to follow the trails to take in the many attractions. All rooms feature a private balcony and free Wifi.

Amenities include: Restaurants, room service, wireless internet, bar, 24 hour reception, swimming pool, gym, tennis, bike hire, casino gaming, air-conditioning.

Per person, per night, room only (\$)

SUPERIOR ROOM	Twin	Single	Triple
April - March	83.50	167.00	78.00
DELUXE ROOM	Twin	Single	Triple
April - March	90.00	180.00	82.40

Bonus: Includes buffet breakfast daily (maximum 2 people).

Stay 4 consecutive nights and pay for only 3 during Apr-Mar.

Booking Code: LASSETER



Rock and Olgas Heli Tour

A breathtaking helicopter flight over one of the most famous natural wonders of the world.

One of the most popular flights by far, you will enjoy the spectacular sights within the Uluru-Kata Tjuta National Park from a unique perspective. You will be collected from your accommodation by the complimentary transfer coach for the short trip to Ayers Rock airport. After a short, but all important safety briefing, you will board the helicopter for a 30 minute scenic flight around Uluru (Ayers Rock) and Kata Tjuta (The Olgas). Take a bird's eye view to appreciate the magnificence of the Red Centre, a natural wonder some only ever dream of seeing. The views are truly amazing and a camera is a must to help you capture memories that will last you a lifetime.

30 Minutes

Cost: \$275pp (adult/pension)
Includes: 30 minute flight, return transfers
Departs: Uluru, daily every 35 minutes
Returns: Approximately 1 hour 10 minutes later
Booking Code: RO



Camel to Sunset

Take a ride through the desert on this trusty form of transport - a camel!

A form of transport you definitely don't see every day. Meander on the back of a friendly camel with the sunset and Uluru as your backdrop. Take your time exploring the rich red sand dunes and watch the awe inspiring scenery of Uluru and Kata Tjuta, which change colour as the sun sets. The skilled cameleers will describe the desert flora and fauna of the Outback landscape surrounding you on your ride and will entertain you with stories about the unique lifestyle of the region. Return to the farm at twilight to enjoy a glass of champagne or beer and taste Outback bush foods including the famous freshly baked beer bread damper.

2.5 Hours

Cost: \$125pp (adult/pension)
Includes: Camel ride, optional safety helmet, nibbles, beer, wine or soft drink, return transfers
Departs: Uluru, daily between 4.30pm & 6.00pm (except 25 Dec & 01 Jan)
Returns: Between 7.00pm & 8.30pm
Booking Code: CS-T



Sounds of Silence Dinner

Enjoy the magic of wining and dining under the canopy of the sparkling Outback sky.

Dine under a million stars at the award-winning Sounds of Silence dinner. Your evening begins as you are escorted to a private, secluded sand dune where the wavering notes of a lone didgeridoo echo across the desert. Enjoy champagne and canapés while you watch the sunset over Uluru and Kata Tjuta and marvel as the colours of the Outback change before your very eyes. At twilight begin your feast on an array of the region's culinary delights such as barramundi, kangaroo and crocodile, as well as a range of gourmet salads. Later, turn your gaze upwards as the resident astronomer takes you on a tour of the stars that blanket the spectacular southern night sky.

4 Hours

Cost: \$195pp (adult/pension)
Includes: Sunset drinks, canapés, gourmet barbecue, entertainment, star talk, star gazing, return transfers
Departs: Uluru, daily 45 minutes prior to sunset (except 25 & 31 Dec)
Returns: 4 hours later
Booking Code: SOUNDS



Uluru Sunrise and Guided Cultural Walk

Enjoy a moment of peace and clarity as the first rays of sunlight peek over the great wonder of Uluru.

Rise early and travel to the sunrise viewing area to witness the first light of a new day over Uluru. After sunrise accompany your guide on the Kuniya Base Walk, then walk to the Mutijulu Waterhole where your guide will indicate the natural features of the landscape, Aboriginal rock paintings and relay traditional stories. Board your coach and continue the tour around the circumference of this massive rock. Walk with your guide along the Mala Walk before continuing to Kantju Gorge, where after rainfall, water can cascade over the side of Uluru and plunge some 90 metres to the ground. Later, visit the Uluru-Kata Tjuta Cultural Centre, learn more about Anangu and Tjukurpa (Anangu beliefs and law). There is also the chance to view and purchase locally made Aboriginal souvenirs.

6 Hours

Cost: \$139pp (adult)
\$125pp (pension)
Includes: Touring, return transfers (not included: National Park entry fee)
Departs: Uluru, daily 90 minutes prior to sunrise
Returns: 12.00pm
Booking Code: Y41



Voyages Outback Pioneer Hotel



Via Yulara Drive, Yulara

Experience traditional Aussie hospitality at the Voyages Outback Pioneer Hotel. Taste Australia's pioneering past, as you enjoy a beer and some Outback delights at the do-it-yourself Outback BBQ. Alternatively, opt for the peace and quiet of the Bough House Restaurant with a buffet dinner. Swap stories of your day's adventures, or sing along with the nightly entertainment, the Outback Pioneer Hotel provides a warm and social atmosphere for all.

Amenities include: Bough House buffet restaurant, bar, nightly entertainment, swimming pool, guest laundry, air-conditioning.

Per person, per night, room only (\$)

STANDARD ROOM	Twin	Single	Triple
April - June	155.00	310.00	120.00
July - November	170.00	340.00	130.00
December - March	155.00	310.00	120.00

Booking Code: Outback



Voyages Emu Walk Apartments



Via Yulara Drive, Yulara

Sheltered behind gardens of native desert trees and forming a walkway through the heart of the Resort, these fully serviced apartments are light and spacious enough to cater for up to six people – ideal if you are holidaying with family or friends. All apartments are self contained with separate kitchen, living and bedroom areas. Located just minutes from the hub of the Town Square, including mini supermarket and shops, the Emu Walk apartments provide everything you need to cook or, if you're not in the mood for cooking, choose from 13 dining experiences throughout the Resort.

Amenities include: Fully equipped kitchen, air-conditioning.

Per person, per night, room only (\$)

ONE BEDROOM APARTMENT	Twin	Single	Triple
April - June	170.00	340.00	130.00
July - November	199.00	398.00	149.40
December - March	170.00	340.00	130.00

Note: Upgrade to Two Bedroom Apartment available at an additional cost.

Booking Code: EMUWALK



Voyages Desert Gardens Hotel



Via Yulara Drive, Yulara

A comfortable hotel at Ayers Rock Resort, Desert Gardens Hotel offers a range of appealing accommodation, from shaded poolside rooms to deluxe rooms with Rock views. Set amongst magnificent ghost gums and flowering native shrubs, you can choose to relax in the comfort of your private balcony or unwind near the pool over cocktails. Perfectly set against the backdrop of Uluru, witness magnificent sunsets from the Resort's numerous lookouts.

Amenities include: A-la-carte restaurant, buffet restaurant, bar, room service, internet access, swimming pool, air-conditioning.

Per person, per night, room only (\$)

STANDARD ROOM	Twin	Single	Triple
April - June	175.00	350.00	133.40
July - November	205.00	410.00	153.40
December - March	175.00	350.00	133.40

Note: Upgrade to Deluxe room available at additional cost.

Booking Code: DESERT



Voyages Sails in the Desert



Via Yulara Drive, Yulara

Named after the soaring white sails that crown its roof, Sails in the Desert Hotel is Ayers Rock Resort's premier hotel. The interior décor focuses on Aboriginal heritage and culture, with the renowned Mulgara Gallery in the hotel and significant artwork featured throughout. Relax in the beautifully appointed rooms, enjoy a cocktail in the lovely grounds, or sit back under the magnificent white sails.

Amenities include: Restaurants, bar, room service, internet access, hair/beauty salon, swimming pool, tennis court, air conditioning.

Per person, per night, room only (\$)

STANDARD ROOM	Twin	Single	Triple
April - June	230.00	460.00	170.00
July - November	270.00	540.00	196.70
December - March	230.00	460.00	133.40

Note: Upgrade to Terrace room available at additional cost.

Booking Code: SAILS

Adelaide and Coober Pedy

Tours and Accommodation

'The Festival City' is famous for its stunning architecture and its close proximity to a wide variety of world-class attractions. When in Adelaide visiting a winery is a must, and as everything is within easy reach, it's the perfect place to discover wine regions like the world-famous Barossa Valley and McLaren Vale. Take some more time out in Adelaide to go cruising on the Murray River, travel back in time to historic

Hahndorf, or get up close and personal with classic Australian wildlife on Kangaroo Island. Take The Ghan north out of Adelaide to the famous town of Coober Pedy, the shining gem of the Outback. Get down and dirty as you dig for opals, or take a walk through the picturesque backdrops of the Painted Desert and Moon Plains. Coober Pedy is also the gateway to the spectacular Lake Eyre and Flinders Ranges.

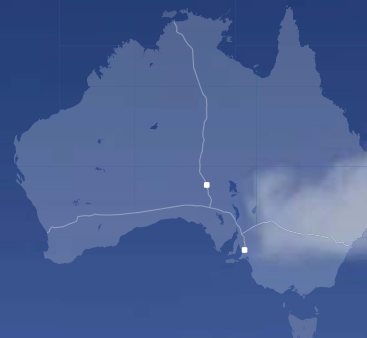

Average Temperatures (Celsius)

December - February	15° - 27°
March - May	12° - 22°
June - August	7° - 16°
September - November	11° - 21°





City Highlights Tour

3 Hours

Not just the city of churches, explore the sights that make Adelaide an increasingly popular destination.

Adelaide is a cosmopolitan blend of European and modern architecture and is renowned for its great food, wine and relaxed lifestyle. This tour is an ideal introduction to the Adelaide way of life. Find out Colonel Light's vision as you overlook the city from the top of Montefiore Hill. Venture past the famous Adelaide Oval and St. Peter's Cathedral before continuing along the cultural hub of North Terrace which is home to two universities, the Art Gallery and State Library. Find out why Adelaide is called the '20 minute city' as you make your way to Glenelg Esplanade for views of the shimmering coastline. Your tour also includes a trip to the home of fresh and local produce, the famous Adelaide Central Market.

Cost: \$64pp (adult/pension)
Includes: Touring, return transfers
Departs: Adelaide, daily at 9.15am (except 25 Dec)
Returns: 12.15pm
Booking Code: AS14



Dolphin Cruise

4 Hours

Dolphins are one of the Earth's most fascinating and curious creatures.

This is a once in a lifetime encounter in which you will be touched forever. This is possibly the only cruise of its type, where we don't go to the dolphins, they come to us – something that has taken many cruises to achieve. 'Temptation' is an 18m colossal sailing catamaran that offers a special experience of viewing wild dolphins in their natural habitat. As with any wild animals, no guarantees can be made. While dolphins are naturally curious creatures and generally love playing around the boat, the interaction is different on each cruise. Swimming with the dolphins is also available (additional cost).

Cost: \$68pp (adult/pension)
 Upgrade to swimming with the dolphins at an additional cost
Includes: Cruising (not included: transfers)
Departs: Adelaide, daily at 7.30am (Nov-Mar), Tue, Thu, Sat & Sun (Apr-14 Jun & 14 Sep-Oct) (except 15 Jun-13 Sep, 25 Dec & 01 Jan)
Returns: 11.30am
Booking Code: DCWAT/SWM



Adelaide Hills and Hahndorf Tour

4 Hour

Venture into the Adelaide Hills and leave modernity behind as you discover the quaint town of Hahndorf.

Make your way to the picturesque Adelaide Hills, which is not only home to the magnificent Mt Lofty Ranges but is also dotted with unique and historic villages and townships. On your tour, experience the beauty of the South Australian countryside and wildlife before exploring Australia's oldest German settlement, Hahndorf. You'll feel as if you've stepped back in time as you wander down the tree lined main avenue past Alphon players and German folk dancers. In your free time, don't forget to visit the local European cafes, pick up some authentic homemade cakes and German smallgoods, Australian arts and crafts stores, the lolly shop, and of course the German style Hahndorf Inn. Join your tour group again for a quick bite of afternoon tea.

Cost: \$68pp (adult/pension)
Includes: Touring, afternoon tea or beer tasting, return transfers
Departs: Adelaide, daily at 1.15pm (except 25 Dec)
Returns: 5.15pm
Booking Code: AS13



Barossa and Hahndorf Wine Experience

1 Day

Discover one of the world's great wine regions, the Barossa and the beautiful Adelaide Hills on this full day wine experience tour.

This comprehensive tour provides a great introduction to the Barossa and Adelaide Hills wine growing regions. The Barossa region is home to more than 160 wineries and with more than 80 cellar doors, and is also renowned for its food and cultural experience. The Adelaide Hills is a picturesque region that boasts more than 90 wine labels and 50 cellar doors. Hahndorf is Australia's oldest German settlement and we finish our tour with a visit to its beautiful historic main street where you can sample some of the local wines and explore the many shops, galleries and cafes.

Cost: \$132pp (adult/pension)
Includes: Touring, wine tasting, lunch, return transfers
Departs: Adelaide, daily at 9.15am (except Good Friday & 25 Dec)
Returns: 5.15pm
Booking Code: AS10



McLaren Vale and Hills Winery Ultimate

1 Day

When in Adelaide, visiting McLaren Vale for wine tasting should be high on your to-do list.

This small group tour takes you to two of South Australia's most picturesque wine regions: McLaren Vale and the Adelaide Hills, where boutique food producers and vineyards thrive. This tour is not about barging through the usual busy tourist areas but about giving you the opportunity to sample excellent local wines and regional foods at leisure. You might even experience some behind the scenes activities. Stop for morning tea in the heart of McLaren Vale, and then continue through various wineries until you've found the perfect drop to accompany your lunch, a platter of regional cuisine. Stops on your wine tasting itinerary include: Fox Creek Winery, The Olive Grove, Woodstock Winery, Longview Winery and Blefari Vineyard. Board your coach back to Adelaide and enjoy the views of the city, suburbs and the coast as you reflect on a magnificent day.

Cost: \$125pp (adult)
\$122pp (pension)

Includes: Touring, morning tea, two course lunch, wine tasting, return transfers

Departs: Adelaide, Mon & Fri at 7.50am (except Good Friday & 25 Dec)

Returns: 5.30pm

Note: Not available to children / infants

Booking Code: PMT09



Barossa Valley Supreme

1 Day

The ultimate wine experience for those who consider themselves a genuine wine connoisseur.

As one of Australia's oldest and best known winemaking regions, the Barossa Valley provides wine lovers with a memorable experience of some 60 wineries. Visit famous chef, Maggie Beer's Farm Shop and browse the wonderful homemade produce. Just next door, the Beer Bros cellar door entices you to try their range of wines. For lunch, visit none other than the Wolf Blass Visitor Centre where you will enjoy a platter made up of regional produce and your choice of wine, followed by tea or coffee. This intimate tour is designed for the more serious wine lovers and provides a brilliant cross section of the finest wines the Barossa Valley has to offer such as Wolf Blass, Langmeil Winery and Chateau Tanunda.

Cost: \$105pp (adult)
\$102pp (pension)

Includes: Touring, regional platter lunch at winery, structured wine tastings, vineyard tour, return transfers

Departs: Adelaide, Tue, Thu, Fri, Sat & Sun at 7.50am (except Good Friday & 25 Dec)

Returns: 5.30pm

Note: Moderate level of fitness required

Booking Code: PMT14



Kangaroo Island Coast to Coast

2 Days

Discover a true South Australian gem, a treasure island only a short ferry ride away.

Explore one of Australia's finest nature-based destinations on this relaxed but comprehensive tour in the comfort of a modern coach. Arrive on the ferry on your first day and visit Clifford's Honey Farm, enjoy a guided tour of Seal Bay and witness the spectacular Birds-of-Prey free flight show. On day two, get up close and personal with animals only unique to Australia by feeding Kangaroo Island kangaroos at Parndana Wildlife Park, spotting koalas relaxing in eucalyptus trees and viewing a Fur Seal colony at Admiral's Arch. You will witness spectacular coastal scenery, virgin bush land and cottage industries only found on this untouched island. More highlights include a penguin walk after dark, wildlife sanctuaries, protected national parks, and natural wonders like Remarkable Rocks.

Cost: From \$606pp twin share (adult/pension)

Includes: Ferry travel, touring, accommodation, lunches, transfers (not included: dinner)

Departs: Adelaide, daily at 6.45am (except 25 Dec)

Returns: 10.30pm

Note: Moderate level of fitness required

Booking Code: CCCC-0



Murray River Wetlands Discovery Cruise

4 Days

All aboard! Sit back and relax as you discover the wonders of the Murray River wetlands.

A short but sweet introduction to the beautiful and historic Murray River between Walkers Flat and Murray Bridge. Cruise through the spectacular riverlands and enjoy the great variety of flora and fauna on the paddle wheeler PS Murray Princess. On the outside she brings her presence of warmth and friendliness to the river and on the inside boasts the character and charm of yesteryear. Enjoy your stay in either one of the private accommodation options, and meet new friends in the spacious lounges and dining saloon. Enjoy meals from the delicious table d'hote menus, Captain's Dinner and buffet breakfasts. There's a fantastic nature walk, a backwater wildlife tour by small vessel, a visit to the township of Murray Bridge and more. (5 and 8 day cruises also available).

Cost: From \$899pp twin share (adult/pension)

Includes: Cruising, guided nature walks, touring, dinner, accommodation, meals, entertainment, return transfers

Departs: Adelaide, Fri at 2.00pm

Returns: 12.00pm

Booking Code: CC3MR



BreakFree Directors Studios



259 Gouger Street, Adelaide

BreakFree Directors Studios is a boutique hotel situated in the heart of Adelaide city, offering comfortable accommodation at an affordable price. For those who want the cultural experiences Adelaide has to offer, the hotel is located near the Art Gallery of South Australia, the museum and state library. It is also located within close proximity to the major Adelaide city attractions such as Rundle Mall and King William Street.

Amenities include: 24 hour reception, room service, guest laundry, car parking, air-conditioning.

Per person, per night, room only (\$)

HOTEL ROOM	Twin	Single	Triple
April - March	59.50	119.00	N/A
STUDIO ROOM	Twin	Single	Triple
April - March	67.00	134.00	56.40

Booking Code: BFDIRECT



Mercure Grosvenor Hotel Adelaide



125 North Terrace, Adelaide

An historic site in its own right, the Mercure Grosvenor Hotel Adelaide is located in the heart of the Adelaide CBD opposite the Convention Centre, Casino and Festival Centre, the hub of Adelaide's entertainment district. The Adelaide Central Market and Glenelg Esplanade are easy to access by hopping on the tram situated directly opposite the Mercure Grosvenor Hotel Adelaide. The hotel offers the warmth and charm of a bygone era with friendly, unobtrusive and attentive service.

Amenities include: Restaurant, room service, wireless internet, car parking, fitness centre, beauty salon, air-conditioning.

Per person, per night, room only (\$)

STANDARD ROOM	Twin	Single	Triple
April - 12 October	75.50	151.00	65.00
13 October - 12 December	80.00	160.00	68.00
13 December - 01 February	75.50	151.00	65.00
02 February - March	80.00	160.00	68.00

Bonus: Stay 4 consecutive nights and pay for only 3 during Apr-Mar.

Booking Code: GROSVENOR



Hotel Grand Chancellor Adelaide on Hindley



65 Hindley Street, Adelaide

Conveniently located right in the heart of Adelaide's cosmopolitan West End art and cultural district, the hotel is within easy reach of shops, outdoor cafes, Rundle Mall and the Casino. Its position makes it the perfect gateway to the city's many historic and unique regions. Enjoy a drink overlooking the cosmopolitan Hindley Street at Sebastian's Bar or make your way to the pool where you can unwind and briefly escape the busy city life.

Amenities include: Restaurant, room service, wireless internet, car parking, swimming pool, fitness centre, air-conditioning, hairdryer.

Per person, per night, room only (\$)

DELUXE ROOM	Twin	Single	Triple
April - March	73.50	147.00	67.00

Booking Code: CENTRA



Grand Chifley Adelaide



208 South Terrace, Adelaide

Situated only one kilometre from the city centre, this hotel is the perfect location for your next holiday in Adelaide. The Grand Chifley Adelaide overlooks the beautiful South Parklands with views east to the Adelaide Hills or west to the Coast. The free city tram is just a one minute walk from the hotel and a great way to get around town. Recently refurbished, the Grand Chifley Adelaide suits everyone.

Amenities include: Restaurant, bar, room service, internet access, swimming pool, complimentary car parking, air-conditioning.

Per person, per night, room only (\$)

STANDARD ROOM	Twin	Single	Triple
April - March	85.00	170.00	69.70
SUPERIOR QUEEN	Twin	Single	Triple
April - March	102.00	204.00	N/A

Bonus: Stay 3 consecutive nights and receive free buffet breakfast for up to 2 people daily during Apr-Mar.

Booking Code: GRCHIFF



Adelaide Accommodation



Rydges South Park Adelaide



1 South Terrace, Adelaide

Rydges South Park Adelaide is located on the edge of the city and close to Adelaide Parklands Rail Terminal. Guests can take advantage of all this fabulous city has to offer, ranging from pristine beaches to world-famous wine growing regions. The hotel is situated next to the South Parklands with views of the Adelaide Hills and has rooms to suit all needs and budgets.

Amenities include: Restaurant, room service, car parking, wireless internet, swimming pool, gymnasium, laundry service, air-conditioning.

Per person, per night, room only (\$)

STANDARD ROOM	Twin	Single	Triple
April - March	86.00	172.00	75.40
SUPERIOR ROOM	Twin	Single	Triple
April - March	99.50	199.00	84.40

Bonus: Stay 2 or more nights and receive a discount.

Booking Code: RYDGESP



Mantra Hindmarsh Square



55-67 Hindmarsh Square, Adelaide

Mantra Hindmarsh Square is located in the elegant seclusion of Hindmarsh Square. It offers the unique combination of a central location with a peaceful environment. Enjoy easy access to all major attractions being within walking distance from the major shopping hub of Rundle Mall. Most rooms offer superb views of the Adelaide Hills. Sports enthusiasts will love the close proximity to the Adelaide Oval, golf course, and V8 Supercar racing circuit.

Amenities include: Restaurant, cocktail lounge, kitchenette, internet access, car parking, gym, guest laundry, air-conditioning.

Per person, per night, room only (\$)

STUDIO ROOM	Twin	Single	Triple
April - March	89.50	179.00	73.00
PARKVIEW SUITE	Twin	Single	Triple
April - March	107.00	214.00	84.70

Note: Studio rooms only have double beds.

Booking Code: SAVHSQ



Majestic Roof Garden Hotel



55 Frome Street, Adelaide

Majestic Roof Garden Hotel is an inner city hotel that oozes personality and charm. Created with the discerning traveller in mind, the interiors of this hotel are an envied mix of cosmopolitan class and flow-through of space and light. The hotel is located 50 metres from the vibrant shopping and dining strip of Rundle Street. Guests are welcome to make their way to the magical roof top gardens where they can relax and unwind with uninterrupted views of the Adelaide Hills.

Amenities include: 24 hour reception, restaurant, room service, internet access, roof garden, gym, guest laundry, air-conditioning.

Per person, per night, room only (\$)

DELUXE KING	Twin	Single	Triple
April - March	90.00	180.00	N/A
EXECUTIVE DELUXE	Twin	Single	Triple
April - March	97.50	195.00	78.40

Booking Code: MAJESTIC



Crowne Plaza Adelaide



16 Hindmarsh Square, Adelaide

The Crowne Plaza Adelaide is located on Hindmarsh Square in the heart of the central business district. Overlooking the gardens of Hindmarsh Square, the hotel enjoys leafy and peaceful surroundings whilst being within walking distance of all the main attractions. Nearby attractions include the Botanic Gardens, National Wine Centre, Adelaide Zoo, Rundle Mall, cafes and restaurants. Also within walking distance are the Adelaide Convention Centre, Adelaide Casino and the tram to Glenelg beach.

Amenities include: 24 hour reception, restaurant, bar, room service, internet access, lap pool, spa, sauna, fitness centre, laundry service, car parking, air-conditioning.

Per person, per night, room only (\$)

STANDARD ROOM	Twin	Single	Triple
April - August	110.00	220.00	97.40
September - March	128.00	256.00	109.40
SUPERIOR ROOM	Twin	Single	Triple
April - August	146.00	292.00	121.40
September - March	163.50	327.00	133.00

Bonus: Stay 2 consecutive nights and receive full breakfast for 2 people daily during Apr-Sep.

Booking Code: CROADL



Desert Cave Town Tour

4 Hours

Make your way underground to a town that functions and thrives right under your feet.

Coober Pedy holds a fascination for visitors from all over the world. What goes on underground? Flashes of rainbow coloured Opal, an easy-going lifestyle, and a chance to strike it rich. An 'underground' town where you could arrive with just the shirt on your back and leave a millionaire! Tour the town, hear about its history, about the precious water supplies and power generation. Every element of life is hard-won in Coober Pedy. Visit a working opal field and see the Breakaways, a range of colourful exposed sandstone outcrops and travel along a portion of the famous Dog Fence, which stretches 5,300km across Australia. There's an underground church and underground 'Dugouts' where you can see how the locals live, even an underground bar where you can enjoy a refreshing drink.

Cost: \$98pp (adult/pension)
Includes: Touring, return transfers
Departs: Coober Pedy, daily at 1.45pm
Returns: 5.45pm
Booking Code: DCTT



Down and Dirty Opal Tour

4 Hours

A hands-on experience; getting down and dirty fossicking for opal.

For those who want to experience the thrill of digging for a fortune, this tour offers a comprehensive hands-on opportunity. View an informative, instructional and entertaining video on opal mining to open up the mysterious world of discovering the stone of fire 'The Coober Pedy Opal'. Visit a working mine field to understand the various styles of opal mining, and to relive the hardship and joy of earlier times. Enter the Quest Mine where you will be supplied with a hard hat, torch and handpick. Get down and get dirty fossicking (noodling) for your own fortune before accessing the 'Jewellers Shop'. Experience a safe, fun and informative way to mine your own opal.

Cost: \$110pp (adult/pension)
Includes: Touring, entry fees, return transfers
Departs: Coober Pedy, daily at 7.45am
Returns: 12.00pm
Booking Code: DDOT



Painted Desert

1 Day

Travel through desert country to a painted canvas that is one of Mother Nature's oldest works of art.

Enjoy this one day 4WD tour to the spectacular breakaway country of the Painted Desert (Arckaringa Hills). The Painted Desert is an area of spectacular colourful hills that Mother Nature has taken 80 million years to create. To get there travel past the last of the underground homes and through the Dingo Fence (the world's longest structure). Travel over an area that was once an ancient inland sea bed but today is commonly known as the Moon Plains. This area is now a great site of discovery for palaeontologists from around world. See some of the vast cattle stations of the Outback, bush walk through the Painted Desert, and experience the beauty of Outback landscapes and waterholes. Learn about the Great Artesian Basin, the early explorers and the pastoral industry.

Cost: \$230pp (adult/pension)
Includes: Touring, morning and afternoon tea, lunch, return transfers
Departs: Coober Pedy, daily at 8.30am
Returns: 5.00pm
Booking Code: PD



Desert Cave Hotel



Hutchison Street, Coober Pedy

Experience 'Dugout' style living, underground shops, bar and opal display areas, all in the heart of the Outback in Coober Pedy. Subject to availability, you can even stay in an underground room! Sleeping underground is a unique experience. Quiet, cool, dark and airy – these rooms are spacious with high ceilings. Some say that sleeping underground gives them the best night's sleep they have ever had.

Amenities include: Pool, spa, sauna, gym, wireless internet, free in-house movies, guest laundry, room service, air-conditioning.

Per person, per night, room only (\$)

HOTEL ROOM	Twin	Single	Triple
April - March	122.50	245.00	97.40

Transfers: (DCTSF) \$96pp (minimum 2 people) or \$192pp (single) must be booked in conjunction with this accommodation.

Booking Code: CAVE

Sydney and Broken Hill

Tours and Accommodation

As Australia's largest city, there really is no end to the sights and attractions you can enjoy here. It's difficult to imagine spending any time in Sydney without visiting icons such as the Sydney Opera House and Sydney Harbour Bridge. Take a day trip down to the ever popular Bondi Beach and immerse yourself in the quirky culture of this beachside town or visit the

renowned Blue Mountains and Jenolan Caves. Nestled on the border of New South Wales and South Australia sits Broken Hill and a surrounding landscape that is full of unusual attractions and travel experiences. It's strong mining history and classic architecture contrasts with its reputation as a haven for artists of both ancient and modern times.



Average Temperatures (Celsius)

December - February	18° - 26°
March - May	14° - 23°
June - August	8° - 18°
September - November	13° - 22°





City Hop On – Hop Off

Your ticket to an action packed day of sightseeing in the bustling town of Sydney.

This tour is an independent and easy way to get around Sydney and its best attractions. The hop on–hop off open-top double decker allows you to discover vibrant Sydney at your own pace. Climb aboard and make your way to the upper deck to soak up the sun and the sights. Stay for a 90 minute guided tour of the city or hop on and hop off all day at any of the 34 stops – it’s up to you! See iconic monuments and buildings that are embedded deep in Australian history and learn quirky facts about some of the oldest buildings, such as the office of Births, Deaths and Marriages, more commonly known as the ‘Hatch, Match and Dispatch’. See Sydney’s best attractions including the Opera House, Harbour Bridge, Botanical Gardens, The Rocks, Woolloomooloo Bay and more.

Day Pass

Cost: \$40pp (adult/pension)
Includes: Full commentary, discount to selected attractions
Departs: Sydney, daily at 9.00am and then at regular intervals (except 25 Dec)
Returns: 1.5 hours later or all day
Booking Code: 201-24



Harbour Coffee Cruise

Jump aboard and fall in love with the charm and character of world famous Sydney Harbour.

Sydney isn’t just about exploring the busy city on land, but seeing the sights by sea. This world renowned cruise to spectacular Middle Harbour and the upper reaches of Sydney Harbour shows you what public and private Sydney are really all about. Covering the Main Harbour attractions including the Opera House, Harbour Bridge and Fort Denison before cruising the magnificent upper reaches of Middle Harbour where palatial waterfront homes, natural parklands, inner harbour beaches and marinas show Sydney life at its best. Relax inside or step out onto the large exterior deck to enjoy the sunshine, shimmering water and fresh sea breeze as you cruise around one of Australia’s most famous harbours. The cruise includes a light morning or afternoon tea to enjoy while you are on the water.

2 Hours

Cost: \$55pp (adult/pension)
Includes: Cruise, light morning or afternoon tea, commentary
Departs: Sydney, daily at 10.00am & 2.15pm from No.6 Jetty, Circular Quay (except 25, 26, 31 Dec, 26 Jan & 14 Feb)
Returns: 12.20pm & 4.35pm
Booking Code: CCSYD



Sydney Sights and Bondi Beach

A tour that ticks all the right boxes as you experience the sights, sounds and spirit of Sydney.

This fantastic tour is a great way to take in many of Sydney’s greatest highlights. From the city to the sea, capture a glimpse of life in this thriving city. Drive through the historical Rocks area, lively Chinatown and captivating, charismatic Darling Harbour. See the famous Sydney Opera House and Harbour Bridge from Mrs Macquarie’s Chair, a specially designed chair for the governor’s wife to look out over Sydney Harbour. Kick off your shoes and dip your toes in the water as you wander across the sandy shores of the world famous Bondi Beach. Feel the world slow down and experience the unique mixture of culture and lifestyle as surfers, skaters, artists and tourists from around the world immerse themselves in all that is Bondi.

4 Hours

Cost: \$59pp (adult)
 \$53pp (pension)
Includes: Touring, return transfers
Departs: Sydney, daily at 1.45pm (except 25 Dec)
Returns: 6.00pm
Booking Code: J6



Blue Mountains and Jenolan Caves

Leave the city behind for a day and escape to the magic and beauty of the Blue Mountains.

This tour takes in the wonders of the beautiful Blue Mountains and Jenolan Caves. Ascend into the Blue Mountains, passing through sleepy townships including its unofficial capital, the historic town of Katoomba. Make sure you have your camera as you pass the Three Sisters rock formation, drive along Scenic Cliff Drive and enjoy views of the beautiful countryside. Enter the Grand Arch of the Jenolan Caves and join an informative and fully guided tour of the limestone caves from the comfort of a walkway. Enjoy time at leisure in the comfort and ambience of Caves House, built in the 1920s and originally a holiday retreat for Sydney’s rich and famous. Don’t forget to wander down to see the stunning and mysterious Blue Lake, and learn about the ‘blue haze’ phenomenon of the Blue Mountains.

1 Day

Cost: \$159pp (adult)
 \$143pp (pension)
Includes: Touring, return transfers
Departs: Sydney, Mon, Tue, Thu & Sat at 8.00am (except 25 Dec)
Returns: 6.15pm
Booking Code: J32



Hotel Ibis World Square



384 Pitt Street, Sydney

Located in the heart of Sydney, you are within an easy walk to Darling Harbour, Cockle Bay, Sydney Convention and Exhibition Centre and Chinatown. The hotel is close to Sydney's shopping precincts, the Entertainment Centre, Capitol Theatre and George Street cinema complexes. A variety of trendy restaurants and bars to suit all tastes and budgets lie within walking distance. Get a real taste of the busy Sydney life from this vibrant location.

Amenities include: 24 hour reception, café, internet access, fitness centre, in-house movies, air-conditioning.

Per person, per night, room only (\$)

STANDARD ROOM	Twin	Single	Triple
April - September	80.00	160.00	N/A
October - 14 December	95.50	191.00	N/A
15 December - January	80.00	160.00	N/A
February - March	95.50	191.00	N/A

Bonus: Stay 3 consecutive nights and pay for only 2 during Apr-Sep.

Booking Code: IBISWSQ



Travelodge Sydney



27 Wentworth Avenue, Sydney

On the edge of the CBD, you will be perfectly positioned to explore Sydney. Superb restaurants, theatres, lively nightclubs and a great range of shops from designer stores to funky boutiques are within close walking distance. Major attractions including Darling Harbour, Entertainment Quarter, Sydney Cricket Ground and the Sydney Allianz Stadium are all easily accessible, as well as being close to more family orientated attractions with the Sydney Aquarium and the Sydney Imax Cinema.

Amenities include: 24 hour reception, internet kiosk, guest laundry, dry cleaning, air-conditioning.

Per person, per night, room only (\$)

GUEST ROOM	Twin	Single	Triple
April - September	89.50	179.00	77.40
October - 14 December	99.50	199.00	84.00
15 December - January	89.50	179.00	77.40
February - March	99.50	199.00	84.00

Bonus: Stay 4 consecutive nights and pay for only 3 during Apr-Sep & 15 Dec-Jan.

Booking Code: TLSYD



Mercure Sydney



818-820 George Street, Sydney

Uniquely situated on George Street close to Central Station and Chinatown, this modern hotel is located right in the heart of Sydney's entertainment district and is only a short stroll to many of Sydney's famous locations. A great hotel for families, the Mercure Sydney is situated close to many great and family friendly attractions such as the Sydney Aquarium, Imax Theatre, Powerhouse Museum, Maritime Museum, QVB and Harbourside Shopping Centre.

Amenities include: Gym, sauna, indoor swimming pool, room service, wireless internet, car parking, air-conditioning.

Per person, per night, room only (\$)

STANDARD ROOM	Twin	Single	Triple
April - September	99.50	199.00	81.00
October - 14 December	120.00	240.00	94.70
15 December - January	99.50	199.00	81.00
February - March	120.00	240.00	94.70

Bonus: Stay 3 consecutive nights and pay for only 2 during Apr-Sep.

Booking Code: MERCURES



Vibe Hotel Sydney



111 Goulburn Street, Sydney

A unique hotel offering chic accommodation in the heart of Sydney, Vibe Hotel Sydney exudes style. It is perfectly positioned for you to easily discover Sydney's vibrant CBD, Surry Hills, Chinatown, World Square and downtown entertainment precinct that offers live theatre and music year round. Sydney's premier tourist destinations like Darling Harbour and Hyde Park are only minutes walk away and with public transport on the doorstep, you are not far from other major attractions.

Amenities include: 24 hour reception, restaurant, bar, room service, internet access, dry cleaning, swimming pool, sauna, gym, air-conditioning.

Per person, per night, room only (\$)

GUEST ROOM	Twin	Single	Triple
April - September	115.00	230.00	99.00
October - 14 December	125.00	250.00	105.70
15 December - January	115.00	230.00	99.00
February - March	125.00	250.00	105.70

Bonus: Stay 4 consecutive nights and pay for only 3 during Apr-Sep & 15 Dec-Jan.

Booking Code: VIBESYD



City Sights and Heritage Tour

3.5 Hours

A tour that encapsulates the rich history of the town commonly referred to as the 'Silver City'.

This tour covers 50km of the unique city of Broken Hill. Listen as your experienced local guide tells you about the impact the enormous wealth of the 'Silver City' had on the development of our great country. This city was founded from the discovery of the richest ore body in the Southern Hemisphere. Hear of the origins of BHP and see the vast differences from the early miner's cottages to the modern homes of today. Visit the Line of Lode Miners Memorial and Visitors Centre, located at the highest point of the Line of Lode overlooking the city. Amongst the surrounding desert landscape, notice the green parklands and lush grass of the Broken Hill Golf Course, something the early pioneers could only have ever dreamed of! There are many wonderful heritage buildings, churches and hotels in the Silver City.

Cost: \$78pp (adult)
\$70pp (pension)

Includes: Touring, return transfers

Departs: Broken Hill, Tue, Wed, Thu & Sat at 9.00am

Returns: 12.30pm

Booking Code: CITY



Taste of the Outback

3 Days

Escape bustling city life and turn a great rail journey into a relaxing short break to Broken Hill.

Designed for return rail travel on the Indian Pacific departing Adelaide, this is a fabulous way to gain a greater understanding of this unique city. You will be met by your guide as you step off the mighty Indian Pacific and will be escorted to your accommodation. The following day depart for an informative tour of Broken Hill as your guide explains the enormous impact the wealth of the 'Silver City' had on the development of Australia. The tour includes a moving visit to the Line of Lode Miners Memorial overlooking the city. See Mundi Mundi Plains and soak up the breathtaking views. In the afternoon you will visit Australia's liveliest ghost town, stop at the infamous Silverton Hotel and Sculptures Symposium where you might have the chance to witness one of Mother Nature's best sunsets.

Cost: \$260pp twin share (adult/pension)

Includes: Touring, accommodation, return transfers (not included: rail fare)

Departs: Meets the Indian Pacific from Adelaide on Tue & Fri in Broken Hill

Returns: Meets the Indian Pacific to Adelaide

Booking Code: ADL2N



Silver Haven Motor Inn



577 Argent Street, Broken Hill

Silver Haven Motor Inn is located on the main street of Broken Hill and within easy walking distance to the town's main attractions. A superb fully licensed a-la-carte restaurant is on site with a strong reputation in the area for its fine food and wine. The Silver Haven is the perfect location to access many of Broken Hill's major attractions such as the world class golf course, Rail Museum, Darling River and Menindee Lakes.

Amenities include: Restaurant, swimming pool, laundry facilities, air-conditioning.

Per person, per night, room only (\$)

SUPERIOR ROOM	Twin	Single	Triple
April - March	63.00	126.00	49.40

Booking Code: SILVER



Ibis Styles Broken Hill



120 Argent Street, Broken Hill

Well located within walking distance to all the great restaurants, clubs and entertainment attractions. Many more of Broken Hill's major attractions are also close by including the Silver City Mint and Art Centre, the Railway and Mineral Train Museum and the Geo Centre which houses the famous Silver Tree. Enjoy fantastic shopping in the heritage main street or simply relax by the swimming pool.

Amenities include: Room service, dining room, BBQ facilities, swimming pool, internet, car parking, air-conditioning.

Per person, per night, room only (\$)

STANDARD ROOM	Twin	Single	Triple
April - March	74.00	148.00	N/A
DELUXE ROOM	Twin	Single	Triple
April - March	89.50	179.00	N/A

Bonus: Includes complimentary continental breakfast daily.

Booking Code: MINEHOST

Perth

Tours and Accommodation

The city might be one of the world's most isolated, but it continues to grow and thrive with activity. Starting or ending your journey on the Indian Pacific in this stunning city is the ideal opportunity to take in some of its many attractions. If you only have a short amount of time, there are plenty of options to explore Fremantle, Rottnest Island and the wine regions of the Swan Valley and Margaret

River. With a few more days you can discover some of Australia's best natural wonders like the amazing dolphins of Monkey Mia and Ningaloo Reef. For the more adventurous, stop off in one of Australia's famous goldfields, Kalgoorlie. Spend time exploring a region remote but rich with history, culture and the most colourful characters, a town like no other.

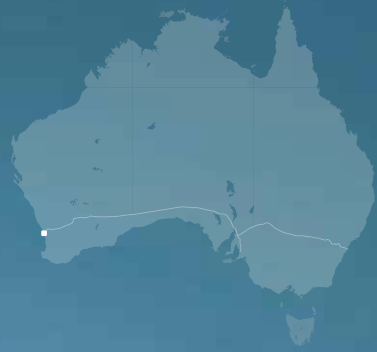

Average Temperatures (Celsius)

December - February	16° - 31°
March - May	13° - 26°
June - August	8° - 18°
September - November	12° - 23°





Upper Swan Lunch Cruise

4 Hours

Head upstream to the beautiful Swan Valley to enjoy quality food, wine and conversation.

Step aboard to enjoy a delicious buffet lunch including a selection of quality Australian produce and a complimentary glass of wine as you depart the city and head upstream. Relax in comfort enjoying the upper reaches of the Swan River while cruising past the Burswood Entertainment Complex, Belmont Park and Ascot racecourses. Immerse yourself in the beauty and calmness of the surroundings as you enjoy a meal with friends new and old. Enjoy the stunning riverside views on your return cruise, afternoon tea is served and live entertainment is provided by the crew.

Cost: \$109pp (adult/pension)
Includes: Cruising, buffet lunch, afternoon tea, wine tasting (not included: transfers)
Departs: Perth, daily (Apr-May & Sep-Mar), Tue, Thu, Fri, Sat & Sun (Jun-Aug) at 1.15pm (except 18 Apr & 25 Dec)
Returns: 4.00pm
Booking Code: SVLC



Perth and Fremantle Explorer

4.5 Hours

A perfect blend of exploration and relaxation as you discover the splendour of Perth and Fremantle.

Starting in Perth, this tour takes in all the major attractions, beginning with Kings Park Botanical Gardens where you can experience a unique way to view the city skyline by walking through the tree canopies on the Tree Top Walkway. Later, continue to famous Cottesloe Beach, world renowned for its stunning bay and superb terraced lawns overlooking the sparkling Indian Ocean. Continue on until you arrive at historic Fremantle where you have the chance to explore and learn about the history of this town. You might even snag a bargain at the weekend markets! The relaxing part of the day begins when you hop aboard a Swan River Cruise back to Perth. Onboard, unwind and absorb the panoramic scenery of Perth as you enjoy a wine tasting while cruising by the extravagant waterfront houses of Millionaires Row.

Cost: \$105pp (adult)
 \$97pp (pension)
Includes: Touring, return transfers
Departs: Perth, daily at 8.00am (except 25 Dec)
Returns: 12.30pm
Booking Code: PFC



Discover Rottnest

1 Day

An island getaway so close you can almost touch it!

Departing from Perth, enjoy a leisurely cruise down the Swan River to Fremantle where you board a high-speed ferry bound for beautiful Rottnest Island. You will quickly discover that Rottnest is a place with an abundance of things to see and do, you won't know what to pick! The Island is famous for its small marsupials known as Quokkas, its pristine beaches and crystal clear bays. Explore the beauty and tranquility of Rottnest as you join a 2 hour coach tour around the Island where your experienced guide provides historical, cultural and natural points of interest. The Island truly is a hive of activity, boasting 63 beaches, 6500 years of history and 50km of road to travel. Take in all the sights and sounds of Rottnest as you enjoy a sumptuous lunch followed by free time for a swim or walk.

Cost: \$189pp (adult)
 \$184pp (pension)
Includes: Touring, cruise, lunch, return transfers
Departs: Perth, daily at 8.30am (except Good Friday, Easter Monday & 25 Dec)
Returns: 6.00pm
Booking Code: DR3



The Triple Tour

1 Day

The old saying 'good things come in threes' couldn't be more true for this touring trifecta.

The Triple Tour is outstanding value and includes three major tourist attractions of Western Australia – a great introduction for any visitor to Perth. Discover Perth city and historic sites on board City Sightseeing's open top double decker bus (half covered during winter and hot summer days). Sit back and enjoy the sights of Perth's best attractions including panoramic views from Kings Park. Then depart Perth on the tranquil waters of the Swan River, cruising past the Old Swan Brewery, Matilda Bay, Royal Perth Yacht Club and Millionaires Row. Enjoy complimentary tea, coffee and an informative Captain commentary. The Fremantle Tram will meet you on arrival and escort you on an informative and scenic tour of the Port City. Have some free time in Fremantle before re-joining the cruise for some Australian wine tasting and a relaxing return trip to Perth.

Cost: \$90pp (adult/pension)
Includes: Touring, cruising, wine tasting (not included: transfers)
Departs: Perth, daily at 9.15am (except 25 Dec & 26 Jan)
Returns: 5.00pm
Booking Code: TRAMCO



Wave Rock and Aboriginal Culture

1 Day

A day enriched with the sights and sounds of Western Australia's natural and man-made history and culture.

Head east through the scenic Darling Ranges to York, the first township founded in the Avon Valley. Enjoy the wonderfully preserved turn of the century Victorian buildings and gain an insight into the grand old days of the pioneers. Continuing east, you pass through sweeping wheat belt plains and stop at the famous Dog Cemetery. Visit the small town of Hyden, where you will see Hippo's Yawn and enjoy a buffet lunch at the Wildflower Shop. Tour Wave Rock; walk around and on top of the rock as you hear stories that are centuries old. Discover Gnamma Holes, visit a wildlife park and see Mulka's Cave. The return journey takes you through Babakin and the Darling Ranges.

Cost: \$215pp (adult)
\$194pp (pension)
Includes: Touring, picnic lunch, return transfers
Departs: Perth, Tue, Wed, Fri & Sun at 8.00am
Returns: 8.30pm
Booking Code: WR



Margaret River and Cape Leeuwin Lighthouse

1 Day

An enchanting region made up of stunning views of both land and ocean.

This tour ensures you get the most out of a day in the area. Head south of Perth and make your first stop at the longest wooden jetty in the southern hemisphere, Busselton Jetty. Discover the stunningly beautiful Margaret River fine wine region and sample wine at a local winery. Enjoy lunch at the Margaret River Brewery, before touring to the Mammoth Cave on a guided tour of one of more than 300 natural underground limestone caves. Pass through the magical Boranup Forest and marvel at the height of the giant Karri trees. Travel to Cape Leeuwin Lighthouse, the dividing point between the Southern and Indian Oceans before enjoying some free time to explore the quaint but chic specialty stores in the Margaret River Township.

Cost: \$215pp (adult)
\$194pp (pension)
Includes: Touring, wine tasting, lunch, entry fees, return transfers
Departs: Perth, Mon, Tue, Thu, Fri & Sat at 8.00am (vineyards closed on public holidays)
Returns: 9.30pm
Booking Code: MR



Pinnacles, New Norcia and Wildflowers

1 Day

An unlikely but fascinating combination of destinations that highlight both Australian history and natural wonder.

This tour combines the history of Australia's only Benedictine Abbey with the world renowned mystical Pinnacles Desert. First, travel through the Swan Valley to New Norcia, a town settled in 1846. Take a guided tour of this Monastic town and discover Abbey Church, St Gertrude's College, the museum and art gallery. Enjoy a picnic lunch before visiting the lobster fishing town of Cervantes. Along the way, stop at the Western Wildflower Farm to learn about how wildflowers are dried and exported. Next, stop at Nambung National Park, home of the Pinnacles Desert. Take a look across the enchanting landscape before taking an easy paced walk through the mystical and huge limestone pillars.

Cost: \$215pp (adult)
\$194pp (pension)
Includes: Touring, lunch, entry fees, return transfers
Departs: Perth, Mon & Thu at 8.00am
Returns: 7.30pm
Booking Code: NN



Valley of the Giants Tree Top Walk

1 Day

The only way is up on this enchanting tour through the treetop canopy of the Valley of the Giants.

Head south through the town of Mandurah, break at Donnybrook, the 'apple town', famous for its apple and stone fruit orchards. Travel through the rolling farmlands of the Blackwood River Valley and pass through the small historic pioneer towns of Balingup and Bridgetown. Stop at the Diamond Tree, one of the three towering trees in the district once used as a bush fire watch tower. Enjoy a picnic lunch and those feeling like a challenge can attempt the climb to the wooden watch cabin. Continue through Karri Forests before reaching the Valley of the Giants. Experience the Tree Top Walk, a 400 metre long elevated walkway constructed through the canopy gradually reaching up to 40 metres above ground level. The views of the forest below are sensational. Visit Denmark and other towns on your way back to Perth.

Cost: \$215pp (adult)
\$194pp (pension)
Includes: Touring, picnic lunch, return transfers
Departs: Perth, Wed at 8.00am (except 25 Dec)
Returns: 10.30pm
Booking Code: TT



Sullivans Hotel Perth



166 Mounts Bay Road, Perth

Sullivans Hotel is situated in Perth's premier location, on the edge of the city centre and adjoining the beautiful Kings Park. Within easy walking distance of the Perth CBD, Swan River, Barrack Street Jetty and Convention Centre the hotel is ideally located for all types of visitors. Catch the free bus from right outside the hotel to access all the main attractions of the city. You will experience exceptional service, friendly staff and great value for money.

Amenities include: 24 hour reception, wireless internet, café, bar, swimming pool, bicycles, car parking, air-conditioning.

Per person, per night, room only (\$)

STANDARD ROOM	Twin	Single	Triple
April - March	90.00	180.00	N/A
DELUXE ROOM	Twin	Single	Triple
April - March	111.50	223.00	N/A

Booking Code: SULLIVAN



Miss Maud Swedish Hotel



97 Murray Street, Perth

Miss Maud Swedish Hotel is a little bit of Sweden in the heart of the city and a landmark in Perth's CBD. The hotel is only a two minute stroll from the city centre, shopping, entertainment and business district. Hotel guests are invited to enjoy a complimentary famous Miss Maud Smörgåsbord Breakfast from the cosy Miss Maud Restaurant. Enjoy friendly service, beautiful surrounds and delicious food.

Amenities include: Restaurant, cafe, room service, 24 hour reception, nightly entertainment, guest laundry, Foxtel, air-conditioning.

Per person, per night, room only (\$)

STANDARD ROOM	Twin	Single	Triple
April - March	125.00	199.00	N/A
SUPERIOR ROOM	Twin	Single	Triple
April - March	152.50	250.00	N/A

Bonus: Includes full breakfast daily.

Booking Code: MISSMAUD



Hotel Ibis Perth



334 Murray Street, Perth

An affordable hotel well-located in the heart of Perth's West End, Hotel Ibis Perth sits just 300 metres from the Murray and Hall Street shopping malls. The hotel bistro serves great value meals daily, and guests can relax after a busy day at Rubix Bar, which bursts into life on weekends. The hotel's stylish bistro and bar offer a great place to relax after a day of shopping.

Amenities include: 24 hour reception, wireless internet, restaurant, bar, car parking, air-conditioning.

Per person, per night, room only (\$)

HOTEL ROOM	Twin	Single	Triple
Apr - Mar (Mon-Thu)	135.50	271.00	110.40
Apr - Mar (Fri-Sun)	85.50	171.00	77.00

Booking Code: IBISPER



Travelodge Perth



417 Hay Street, Perth

Situated in the heart of the CBD, Travelodge Perth is nestled in a picturesque area, close to major shopping malls and a short stroll from the beautiful Swan River. Bordered by the famous Kings Park Botanical Gardens visitors to Perth can take advantage of the free city bus service, which will guide them to the city's major attractions. Travellers will be delighted by the great city location and fabulous facilities.

Amenities include: Restaurant, bar, room service, wireless internet, gym, air-conditioning.

Per person, per night, room only (\$)

GUEST ROOM	Twin	Single	Triple
April - September	113.00	226.00	93.40
October - 14 December	135.00	270.00	108.00
15 December - January	113.00	226.00	93.40
February - March	135.00	270.00	108.00

Bonus: Stay 4 consecutive nights and pay for only 3 during 15 Dec-Jan.

Booking Code: TLPER



Perth Accommodation



Mercure Perth



10 Irwin Street, Perth

Conveniently located in the heart of the city and within strolling distance to the CBD, main shopping malls, entertainment, cafes and Swan River. Mercure Perth offers a variety of wining and dining options; including an a-la-carte restaurant, licensed café and lobby bar. For those wanting to unwind, an unexpected leisure oasis awaits on the rooftop; with a heated outdoor pool, spa, sauna and gymnasium.

Amenities include: 24 hour reception, internet access, restaurant, bars, room service, gym, spa, sauna, heated swimming pool, air-conditioning.

Per person, per night, room only (\$)

STANDARD ROOM	Twin	Single	Triple
Apr - Mar (Mon-Thu)	155.50	311.00	123.70
Apr - Mar (Fri-Sun)	105.50	211.00	90.40

Booking Code: MERPERTH



Mantra on Hay



201 Hay Street, Perth

Ideally located in downtown Perth within walking distance to major department stores, the shopping arcades of Hay and Murray Streets, the Perth Mint, and Swan River. The WACA cricket ground, Gloucester Park, Burswood Casino, and lush Queens Gardens are all within easy reach as are Wellington Square and a host of boutique stores for premier shopping. If multicultural cuisine and vibrant bar and nightlife are your thing, you will also find Perth's burgeoning dining precinct a short stroll away.

Amenities include: 24 hour reception, restaurant, cocktail bar, room service, gym, swimming pool, car parking, air-conditioning.

Per person, per night, room only (\$)

ONE BEDROOM	Twin	Single	Triple
April - March	164.50	329.00	123.00
TWO BEDROOM	Twin	Single	Triple
April - March	179.50	359.00	133.00

Booking Code: SAVPER



Crowne Plaza Perth



54 Terrace Road, Perth

Overlooking the Swan River and within walking distance to Perth CBD, major retail precinct and the surrounding parklands. The restaurant is a great place to satisfy your appetite while you sit back with a delicious Margaret River wine. The hotel offers all the facilities you would expect from a 4.5 star hotel in an intimate and contemporary setting.

Amenities include: Restaurant, bar, room service, wireless internet, guest laundry, valet guest parking, swimming pool, health club, fitness centre, air-conditioning.

Per person, per night, room only (\$)

STANDARD ROOM	Twin	Single	Triple
April - November	122.00	244.00	110.40
December - January	86.00	172.00	86.40
February - March	122.00	244.00	110.40

Booking Code: CROPER



Adina Apartment Hotel Perth



33 Mounts Bay Road, Perth

Access all areas of Australia's fastest growing city from the comfort and convenience of your ideally located hotel apartment. Adina Apartment Hotel Perth is surrounded by popular eateries, bistros and cafes, theatres, gyms and boutique shops. Situated on site at the Perth Convention and Exhibition Centre in the heart of the city, Adina Apartment Hotel Perth has efficient public transport right at the door and is walking distance to Kings Park, Northbridge and Subiaco.

Amenities include: 24 hour reception, internet access, restaurant, room service, swimming pool, sauna, gym, laundry service, air-conditioning.

Per person, per night, room only (\$)

STUDIO ROOM	Twin	Single	Triple
April - September	159.20	319.00	N/A
October - 14 December	179.50	359.00	N/A
15 December - January	159.20	319.00	N/A
February - March	179.50	359.00	N/A

Bonus: Stay 4 consecutive nights and pay for only 3 during 15 Dec-Jan.

Booking Code: MEDPER

Fares and Timetables

Want to tailor your rail adventure to your own needs? Start here with our listing of fares and timetables. Get a feel for the duration of the journey by referring to each timetable, use the fare guides to plan your holiday budget, and learn about the regions you will be travelling through by referring to our included map. Your ultimate rail adventure starts here!





The Ghan Fares (valid 01/04/2014 to 31/03/2015)

\$ Per Person One Way	Private Carriage ^o	Platinum Service*		Gold Service		Red Service		
		Everyday	Low +	Twin Cabin*	Single Cabin	Day/Nighter Seat		
Adelaide-Darwin/Katherine or vv								
Adult	3049	3489	3139	2349	1879	2099	1679	889
Australian Pensioner#/CSHC#/Child	3049	3489	3139	1622	1622	1452	1452	415
BackPacker/Student/YHA~	3049	3489	3139	2349	1879	2099	1679	499
Adelaide-Alice Springs or vv								
Adult	2359	2359	2099	1219	969	1089	869	449
Australian Pensioner#/CSHC#/Child	2359	2359	2099	841	841	753	753	210
BackPacker/Student/YHA~	2359	2359	2099	1219	969	1089	869	269
Alice Springs-Darwin or vv								
Adult	2359	2359	2099	1219	969	1089	869	449
Australian Pensioner#/CSHC#/Child	2359	2359	2099	841	841	753	753	210
BackPacker/Student/YHA~	2359	2359	2099	1219	969	1089	869	269

Advance Purchase Fares are available for bookings made 6 months in advance on selected services and sectors, offering discounts of up to 25%. May not be available for all Concession types. Visit www.greatsouthernrail.com.au for details. (Subject to availability).

The Ghan Timetable (valid 01/04/2014 to 31/03/2015)

Adelaide-Alice Springs-Darwin			Darwin-Alice Springs-Adelaide		
	Operates All Year	Additional Services Operate 21 May to 20 Aug 2014		Operates All Year	Additional Services Operate 24 May to 23 Aug 2014
	Sunday	Wednesday		Wednesday	Saturday
Depart Adelaide	12.20pm	12.20pm	Depart Darwin	10.00am	9.00am
	Monday	Thursday	Arrive Katherine	1.40pm	12.40pm
Arrive Alice Springs	1.45pm	1.45pm	Depart Katherine	6.20pm	4.45pm
Depart Alice Springs	6.00pm	6.00pm		Thursday	Sunday
	Tuesday	Friday	Arrive Alice Springs	9.10am	10.45am
Arrive Katherine	9.00am	9.00am	Depart Alice Springs	12.45pm	2.45pm
Depart Katherine	1.00pm	1.00pm		Friday	Monday
Arrive Darwin	5.30pm	6.30pm	Arrive Adelaide	12.30pm	12.30pm

The Ghan Motorail Vehicle Costs \$ (valid 01/04/2014 to 31/03/2015)

Accompanied Fares	Standard	Special Offer [^]
	Up To 5.5m Length	Platinum and Gold Service \$
Adelaide-Darwin	1189	589
Darwin-Adelaide	649	319
Alice Springs-Darwin	499	249
Darwin-Alice Springs	499	249
Alice Springs-Adelaide	499	249
Adelaide-Alice Springs	949	469

Take the time to immerse yourself in the natural beauty of the Australian countryside without the hassle of driving.

Just sit back, relax and gaze into the distance as your chosen train weaves effortlessly toward its destination. With our Motorail Service, you can avoid the traffic and the long drive, yet still have the convenience of having your own car there for you when you arrive. All you have to do is pack your car with all your holiday gear and check it into the rail terminal on your departure day. Then, while you travel in the comfort of the train, your car enjoys a rest aboard one of our purpose-built vehicle transporters. Please ask your holiday consultant for details.

Darwin Rail Terminal Transfers: The Darwin Rail Terminal is situated approximately 20 minutes drive south of the city centre. Coach transfers are available. Please ask your holiday consultant for details. The Ghan will depart once per fortnight during December 2014 and January 2015. Please note: Great Southern Rail will be operating a special event service of The Ghan over the ANZAC public holiday, departing 23 April 2014. For more details on this service, please ask your holiday consultant.

^o Private Carriage fares are based on a minimum of 6 passengers. 7th/8th person pricing for The Chairman's Carriage available on request.

* Fares based on twin share per person with single supplements applicable.

[^] Low Season fares on The Ghan are available for travel 01 November 2014 to 31 March 2015 for bookings made a minimum of 30 days in advance.

Refer to our Terms and Conditions on page 68 for Australian Pensioner and Commonwealth Seniors Health Card Holders (CSHC) fares.

~YHA Fares are only available to those holding a valid membership card to YHA. Backpacker Fares are only available to those holding a valid membership card from a major recognised Backpacker organisation.

Notes: Return fares are generally double the one way fare. All fares inclusive of fuel price surcharge. Other sector fares available on application. For Motorail, vehicles over 5.5m in length fares available on application.

[^]Special Motorail offer valid with the purchase of a Platinum or Gold Service ticket. Car booking must be made at time of rail service booking. Limited to vehicles up to 5.5m in length. Strictly non-refundable.

All fares and timetables are subject to change without notice.



Indian Pacific Fares (valid 01/04/2014 to 31/03/2015)

\$ Per Person One Way	Private Carriage ^o	Platinum Service*	Gold Service		Red Service
			Twin Cabin*	Single Cabin	Day/Nighter Seat
Sydney-Perth or vv					
Adult	3259	3999	2489	2239	899
Australian Pensioner#/CSHC#/Child	3259	3999	1742	1569	507
BackPacker/Student/YHA~	3259	3999	2489	2239	499
Adelaide-Perth or vv					
Adult	2429	2949	1799	1599	569
Australian Pensioner#/CSHC#/Child	2429	2949	1236	1100	319
BackPacker/Student/YHA~	2429	2949	1799	1599	329
Sydney-Adelaide or vv					
Adult	1389	1399	869	779	389
Australian Pensioner#/CSHC#/Child	1389	1399	705	625	220
BackPacker/Student/YHA~	1389	1399	869	779	219

Advance Purchase Fares are available for bookings made 6 months in advance on selected services and sectors, offering discounts of up to 25%. May not be available for all Concession types. Visit www.greatsouthernrail.com.au for details. (Subject to availability).

Indian Pacific Timetable (valid 01/04/2014 to 31/03/2015)

Sydney-Adelaide-Perth			Perth-Adelaide-Sydney		
	Operates All Year	Additional Services Operate 31 Aug to 15 Nov 2014		Operates All Year	Additional Services Operate 03 Sep to 19 Nov 2014
	Wednesday	Saturday		Sunday	Wednesday
Depart Sydney	2.55pm	2.55pm	Depart Perth	11.55am	11.55am
	Thursday	Sunday	Arrive Kalgoorlie	10.30pm	9.50pm
Arrive Broken Hill	6.30am	6.40am		Monday	Thursday
Depart Broken Hill	8.20am	8.20am	Depart Kalgoorlie	1.20am	1.40am
Arrive Adelaide	3.05pm	3.05pm		Tuesday	Friday
Depart Adelaide	6.40pm	6.40pm	Arrive Adelaide	7.20am	7.20am
	Friday	Monday	Depart Adelaide	10.15am	10.00am
Arrive Kalgoorlie	7.10pm	7.10pm	Arrive Broken Hill	5.25pm	4.35pm
Depart Kalgoorlie	10.40pm	10.40pm	Depart Broken Hill	7.40pm	6.30pm
	Saturday	Tuesday		Wednesday	Saturday
Arrive Perth	9.10am	9.10am	Arrive Sydney	11.10am	10.15am

Indian Pacific Motorail Vehicle Costs \$ (valid 01/04/2014 to 31/03/2015)

Accompanied Fares From-To	Standard	Special Offer [^]
	Up To 5.5m Length	Platinum and Gold Service \$
Adelaide-Perth	949	469
Perth-Adelaide	449	219
Sydney-Perth	1299	649
Perth-Sydney	989	489
Sydney-Adelaide	499	249
Adelaide-Sydney	699	349

Motorail Length, Width and Height Restrictions

For more detailed information please call your holiday consultant for your Motorail Loading Guide. Motorail carriage on all Great Southern Rail services is subject to certain conditions of carriage. These can be obtained from our website www.greatsouthernrail.com.au or by calling 13 21 47.

^o Private Carriage fares are based on a minimum of 6 passengers. 7th/8th person pricing for The Chairman's Carriage available on request.

* Fares based on twin share per person with single supplements applicable.

Refer to our Terms and Conditions on page 68 for Australian Pensioner and Commonwealth Seniors Health Card Holders (CSHC) fares.

~YHA Fares are only available to those holding a valid membership card to YHA. Backpacker Fares are only available to those holding a valid membership card from a major recognised Backpacker organisation.

Notes: Return fares are generally double the one way fare. All fares inclusive of fuel price surcharge. Other sector fares available on application. 31 August 2014 operates Adelaide to Perth only. 19 November 2014 operates Perth to Adelaide only. For Motorail, vehicles over 5.5m in length fares available on application.

[^]Special Motorail offer valid with the purchase of a Platinum or Gold Service ticket. Car booking must be made at time of rail service booking. Limited to vehicles up to 5.5m in length. Strictly non-refundable.

All fares and timetables are subject to change without notice.



The Overland Fares (valid 01/04/2014 to 31/03/2015)

\$ Per Person One Way	Private Carriage ^o	Red Premium Service	Red Service
Adelaide-North Shore Geelong/Melbourne or vv			
Adult	729	179	129
Australian Pensioner#/CSHC#/Child	729	115	66
BackPacker/Student/YHA~	729	179	69
Adelaide-Ararat or vv			
Adult	729	132	95
Australian Pensioner#/CSHC#/Child	729	87	50
BackPacker/Student/YHA~	729	137	69
Adelaide-Horsham or vv			
Adult	729	112	80
Australian Pensioner#/CSHC#/Child	729	75	44
BackPacker/Student/YHA~	729	112	69
Murray Bridge-Melbourne or vv			
Adult	729	168	121
Australian Pensioner#/CSHC#/Child	729	109	62
BackPacker/Student/YHA~	729	168	69

The Overland Timetable (valid 01/04/2014 to 31/03/2015)

Adelaide-Melbourne			Melbourne-Adelaide		
Operates All Year			Operates All Year		
	Monday	Friday		Tuesday	Saturday
Depart Adelaide	7.45am	7.45am	Depart Melbourne	8.05am	8.05am
Depart Murray Bridge	9.49am	9.49am	Depart NS Geelong	9.42am	9.42am
Depart Bordertown	11.42am	11.42am	Depart Ararat	11.41am	11.40am
Depart Nhill	1.05pm	1.05pm	Depart Stawell	12.04pm	12.04pm
Depart Dimboola	1.34pm	1.34pm	Depart Horsham	12.55pm	12.55pm
Depart Horsham	1.58pm	1.58pm	Depart Dimboola	1.18pm	1.18pm
Depart Stawell	2.54pm	2.54pm	Depart Nhill	1.43pm	1.43pm
Depart Ararat	3.31pm	3.31pm	Depart Bordertown	2.08pm	2.08pm
Depart NS Geelong	5.38pm	5.38pm	Depart Murray Bridge	4.05pm	4.05pm
Arrive Melbourne	6.50pm	6.50pm	Arrive Adelaide	5.53pm	5.53pm

The Overland Motorail Vehicle Costs \$ (valid 01/04/2014 to 31/03/2015)

Accompanied Fares	Standard
From-To	Up To 5.5m Length
Adelaide-Melbourne	259
Melbourne-Adelaide	259

Motorail Length, Width and Height Restrictions

For more detailed information please call your holiday consultant for your Motorail Loading Guide. Motorail carriage on all Great Southern Rail services is subject to certain conditions of carriage. These can be obtained from our website www.greatsouthernrail.com.au or by calling 13 21 47.

^o Private Carriage fares are based on a minimum of 6 passengers. 7th/8th person pricing for The Chairman's Carriage available on request.

Refer to our Terms and Conditions on page 68 for Australian Pensioner and Commonwealth Seniors Health Card Holders (CSHC) fares.

~YHA Fares are only available to those holding a valid membership card to YHA. Backpacker Fares are only available to those holding a valid membership card from a major recognised Backpacker organisation.

Notes: Return fares are generally double the one way fare. All fares inclusive of fuel price surcharge. Other sector fares available on application. For Motorail, vehicles over 5.5m in length fares available on application. All fares and timetables are subject to change without notice.

Frequently asked questions



What is the earliest time I can check-in for my train departure?

The earliest time you may check-in for your rail service is approximately 2 hours prior to the train's scheduled departure time (times may vary, please call 13 21 47 for further details). Please note that Great Southern Rail ask all guests to check-in at least 1 hour prior to departure.

Can I fly out the same day as the train arrives?

We highly recommend that guests allow for at least 3-5 hours after the scheduled arrival time of a train, or preferably an overnight stopover (especially for international flights) before a plane flight. Unfortunately, trains can sometimes be delayed and run behind schedule.

What medical assistance is provided by train staff?

Great Southern Rail staff members are trained to administer basic first aid; however staff members are not able to provide assistance with ongoing medical conditions during a journey. Guests requiring medical attention or mobility assistance onboard any of our trains are required to arrange for their own carer to travel with them.

Can my necessary medication be refrigerated?

Yes, subject to space within our onboard fridge compartments. Please inform us of any medication requirements at the time of booking.

Can I take oxygen onboard?

Yes, please inform us of any oxygen requirements at the time of booking.

Is there any EFTPOS/Credit Card facilities onboard the train?

You are able to purchase meals, snacks and beverages using a credit card onboard; however, there are no EFTPOS or cash out facilities available onboard our trains.

What is the standard of dress whilst onboard the train?

Smart casual attire is suggested for guests travelling in Platinum and Gold Service. Neat casual attire is required in Red Service. Warm clothes are recommended for evenings onboard the train, as the air-conditioning can be cool. It is recommended that guests pack a hat, sunscreen and comfortable walking shoes for off-train touring. Sensible shoes are advisable for walking between carriages.

Can I take any pets or animals onboard?

No, the only animals permitted on Great Southern Rail train services are specially trained dogs for the vision and hearing impaired.

As an overseas visitor to Australia, do I qualify for the pension concession fare if I am a pensioner or senior citizen back home?

As part of our agreement with the Australian Government, we must secure an eligible Australian Pension Concession Card number at the time of booking. This agreement with the Australian Federal Government does not extend to pensioners from overseas countries. It is strictly limited to Australian pensioners who are residents of Australia.

Can I take my walking frame/wheelchair/scooter onboard the train?

No, these items must be checked in as stored luggage. A specially modified wheelchair can be requested for use onboard the train (with the assistance of a carer or travelling companion). Please inform us at the time of booking if you require a wheelchair.

What are the parking arrangements at the railway station?

Parking facilities at all Great Southern Rail stations and terminals are provided on a short-term basis only. It is not possible to park your vehicle in the car parks of our stations and terminals for extended periods due to safety concerns.

Can I store my luggage at the railway station?

The following details apply for each terminal/station in the Great Southern Rail network:

Adelaide:

Storage is available on the day of departure only; no overnight luggage storage is available.

Perth:

No luggage storage facilities are available.

Melbourne:

Self storage luggage lockers are available inside Southern Cross Station. Costs start from \$6.00 per locker.

Sydney:

Luggage storage may be organised through CountryLink at their luggage check-in area adjacent Platform 1. Luggage may only be stored on the day of departure and costs start from \$4.40 per item.

Alice Springs:

No luggage storage facilities are available.

Katherine:

No luggage storage facilities are available.

Darwin:

No luggage storage facilities are available.

What is the address of the railway station?

Adelaide:

Adelaide Parklands Terminal (Keswick Terminal), Richmond, Off Sir Donald Bradman Drive, South Australia

Perth:

East Perth Station, West Parade, East Perth, Western Australia

Melbourne:

Melbourne Southern Cross Station, Cnr Collins and Spencer Street, Melbourne, Victoria

Sydney:

Sydney Central Station, City Circle, Sydney, New South Wales

Alice Springs:

Alice Springs Train Station, George Crescent, Alice Springs, Northern Territory

Katherine:

Katherine Railway Station, Railway Terrace Katherine, Northern Territory

Darwin:

Darwin Train Station, Berrimah Road, East Arm, Northern Territory

Terms and Conditions

Terms and Conditions

The following terms and conditions constitute an agreement between you and Great Southern Rail Travel Pty Ltd. By booking train travel, a trip/holiday package, accommodation, day tour or overnight tour with us, you will be deemed to have accepted the Terms and Conditions of this agreement. Therefore please read the following agreement carefully.

Train Travel Conditions of Carriage

Travel on all Great Southern Rail train services is subject to certain additional Conditions of Carriage which you accept when you travel with Great Southern Rail. The full Conditions of Carriage ("the Conditions") may be obtained from your booking agent or any office of Great Southern Rail upon request, and can also be found on Great Southern Rail's website at www.greatsouthernrail.com.au

Train Fares and Prices

Fares apply for booked dates of travel, but are subject to change without notice. Return rail fares are generally double the one way fares. Discount fares may be advertised from time to time but these may carry different conditions that are communicated at time of booking. These fares may not be available for all Concession types.

All fares include a fuel price surcharge.

All rail fares, prices and packages are quoted in Australian dollars inclusive of GST, and are valid for the booked dates of travel. Fares, packages and prices are subject to change without notice.

Hotel Accommodation prices are quoted in Australian dollars inclusive of GST, and are valid at time of booking. Hotel Accommodation and prices are subject to change without notice.

Day Tour and Overnight Tour prices are quoted in Australian dollars inclusive of GST, and are valid at time of booking. Day Tour and Overnight Tour prices are subject to change without notice.

Fitness For Travel

Before making a reservation, you must advise Great Southern Rail if you are ill, injured or have a medical condition which may make it unsafe for you or other guests travelling onboard our trains. The full terms and conditions of the Great Southern Rail's Fitness For Travel Policy may be obtained from your booking agent or any office of Great Southern Rail upon request, and can also be found on Great Southern Rail's website at www.greatsouthernrail.com.au

Bookings and Payment Terms and Conditions

Platinum Service Everyday Fare, Gold Service Everyday Fare & Holiday Package Bookings:

For bookings made greater than 45 days prior to travel a deposit of 10% will be required at the time of booking. The balance of payment will be due at 45 days prior to the date of travel.

For bookings made at 45 days or less prior to travel, full payment will be required at the time of booking.

Holiday package bookings cannot be made less than 4 days prior to the date of travel. For rail only bookings to be made less than 4 days from the proposed date of travel please contact Great Southern Rail on 13 21 47.

Tickets are valid for 12 months from date of purchase.

Platinum Service, Gold Service – Advance Purchase Fare:

Advance Purchase fares are subject to availability. In order to receive the Advance Purchase fare, bookings must be made a minimum of 6 months in advance.

For bookings made greater than 6 months prior to travel a deposit of 10% will be required at the time of booking. The balance of payment will be due at 6 months prior to the date of travel.

For bookings made at 6 months prior to travel, full payment will be required at the time of booking.

Tickets are valid for 12 months from date of purchase.

May not be available for all Concession types.

Platinum Service, Gold Service – The Ghan Low Season Fare:

To receive the Low Season fare, bookings must be made a minimum of 30 days in advance.

For bookings made greater than 45 days prior to travel a deposit of 10% will be required at the time of booking. The balance of payment will be due at 45 days prior to the date of travel.

For bookings made at 45 days or less prior to travel, full payment will be required at the time of booking.

Holiday package bookings cannot be made less than 4 days prior to the date of travel. For rail only bookings to be made less than 4 days from the proposed date of travel please contact Great Southern Rail on 13 21 47.

Tickets are valid for 12 months from date of purchase.

Not available for Concession Card Holders.

Red Service – Day/Nighter Seat Everyday Fare:

Full payment will be required at the time of booking.

Tickets are valid for 12 months from date of purchase.

Red Service – Day/Nighter Seat Rail Saver Fare:

Bookings made through Great Southern Rail's Travel Centre will incur a \$20 booking fee. Full payment will be required at the time of booking.

Tickets are valid for 6 months from date of purchase.

Red Service – Day/Nighter Seat ReadyRail Fare:

Bookings can only be made on Great Southern Rail's website at www.greatsouthernrail.com.au Full payment will be required at the time of booking.

Tickets are valid for date of travel only.

Red Service – Day/Nighter Seat Rail Saver and ReadyRail Fares have limited availability.

Great Southern Rail reserves the right to charge an additional fee for transactions paid by credit card.

Different booking and payment conditions may apply to special offers. These will be advised at the time of booking.

Great Southern Rail Travel Pty Ltd reserves the right to accept waitlist bookings if you fail to comply with these payment conditions.

Different booking and payment conditions may apply to accommodation or tours. These will be advised at the time of booking.

Where a booking is on request through a third party supplier, cancellation and amendment fees will not apply if that booking cannot be confirmed.

An on request booking will not be accepted until confirmed by the third party supplier.

Concession Fares

Pensioners, Commonwealth Seniors Health Card holders and Children must meet the following respective criteria to be eligible for Concession Fares:

Pensioner Fares: Must hold a valid Australian PCC Card.

Australian Commonwealth Seniors Health Card Holder: Must hold a valid card.

To receive concessional travel fares, Great Southern Rail is required to confirm your eligibility for the concession electronically with Centrelink. If you do not want this to happen you will need to contact Centrelink or the Department of Veterans' Affairs (DVA) to obtain a Pension Concession Letter as proof of your eligibility for the concession and provide this directly to Great Southern Rail before the concession can be given.

Pensioner and Commonwealth Seniors Health Card Holders may be entitled to Concession Fares that are partly or fully funded by the Commonwealth or State governments. To qualify for Concession Fares, Australian Pensioner or Commonwealth Seniors Health Cards must be presented at the time of booking, must be valid at the time of travel and must be carried at all times during travel. Not all sectors are included in arrangements for the funding of concessions. Funding for concessions may be withdrawn subsequent to the printing of this document and any prices quoted may therefore change without notice.

Child Fares: Are available to children aged 4-15 years inclusive or where a child occupies a seat or berth. Infants travel free on Great Southern Rail services unless the infant is to occupy a seat or berth. In this instance, the infant is to be booked as a child, and the Child fare applies.

Cancellation Fees

The following fees apply in the event of cancellation:

Platinum Service Everyday Fare, Platinum Service The Ghan Low Season Fare, Gold Service Everyday Fare, Gold Service The Ghan Low Season Fare & Holiday Package Bookings:

More than 45 days before departure: Loss of the standard 10% deposit.

14-45 days before departure: 50% of total cost.

Less than 14 days before departure and after departure: No refund.

Platinum Service, Gold Service – Advance Purchase Fare:

More than 6 months before departure: Loss of the standard 10% deposit of total cost.

3-6 months before departure: 50% of total cost.

Less than 3 months before departure and after departure: No refund.

Red Service – Day/Nighter Seat Everyday Fare:

More than 45 days before departure: Loss of 10% of booking value.

14-45 days before departure: 50% of total cost.

Less than 14 days before departure and after departure: No refund.



Red Service – Day/Nighter Rail Saver Fare:

At any time: No refund.

Red Service – Day/Nighter ReadyRail Fare:

At any time: No refund.

A transfer to another rail fare, special offer or holiday package may be treated as a cancellation, in which case the cancellation fees set out in this document will apply.

Individual accommodation or tour operator payment terms and cancellation conditions may vary from those stipulated by Great Southern Rail. In this event the individual operators conditions will be disclosed at time of booking and apply accordingly to your booking.

Tours

Specific cancellation conditions are subject to these Tours:

- Captain Cook Cruises, all cruises - within 59-30 days = \$200, within 29-15 days = 50%, within 14 days = 100%.

Refunds

Lost vouchers/tickets are not refundable. Unused trip/holiday/ package components are not refundable. Claims for refunds will be subject to a minimum processing fee of \$50. Refunds and substitutions are offered with the express understanding that the receipt by the customer is a waiver of additional remedies.

No refunds will be payable in connection with airline or train delays, unused services, or other acts beyond the control of Great Southern Rail Travel Pty Ltd.

Amendments

Modification of a confirmed booking in Platinum Service, Gold Service, Red Service - Day/Nighter Seat Everyday Fare may result in you incurring an amendment fee of \$20 in addition to any costs charged by operators.

Modification of a confirmed Holiday Package booking will result in you incurring an amendment fee of \$20 in addition to any costs charged by operators and can not be made less than 14 days prior to the date of travel.

Modification of a confirmed Everyday Fare booking in Platinum Service and Gold Service can not be made less than one (1) day prior to the date of travel.

Modification of a confirmed Advance Purchase booking in Platinum Service and Gold Service will result in you incurring an amendment fee of \$20 and can not be made less than 3 months prior to the date of travel with only one (1) amendment permitted.

Modification of a confirmed booking in Red Service - Day/Nighter Seat Everyday Fare can not be made less than one (1) day prior to the date of travel.

Modification of a confirmed booking in Red Service – Day/Nighter Seat Rail Saver Fare will result in you incurring an amendment fee of \$20 and must occur no less than 30 days prior to travel.

Modification of a confirmed booking in Red Service – Day/Nighter Seat ReadyRail Fare is not permitted.

An amendment is a change to an existing booking with the same inclusions. A transfer to another rail fare, special offer or holiday package may be treated as a cancellation, in which case the cancellation fees set out in this document will apply.

Tours

Specific Amendment fees apply to specific tour operators.

- Pinnacle Tours, extended tours – \$25 per amendment once booking has been confirmed.

Airlines

There are a number of airfares that can be booked in conjunction with your holiday package. Strict ticketing deadlines and conditions apply. Airfares are subject to availability at time of booking.

Airlines are involved in trips/holidays as carriers only. The airlines carry no responsibility for statements made in this brochure relating to the trips/holidays.

Accommodation

All rooms subject to availability. Single rooms are available upon request and a supplement is payable. Triple room rates and child rates provided on application and subject to availability. The third bed may be a 'foldaway' or 'rollaway' bed for triple share rooms. Accommodation prices are subject to change without notice.

Hotel rooms are assigned at the discretion of each hotel property. All rooms are not the same, and Great Southern Rail Travel Pty Ltd has no control over room assignments. Alternative hotels of a similar standard to those outlined in packages within this brochure may be used without notice. The star rating system for hotels is provided as an indication of the standard of the hotels only, and the ratings are subject to change without notice.

Hotels may require a credit card imprint on check in or alternatively a cash bond.

Touring

Great Southern Rail Travel Pty Ltd does not own, operate or control third party suppliers of services (eg. airlines, hotels/ accommodation, sightseeing tour operators, transportation companies, restaurants, hire car operators). To the extent permitted by law, Great Southern Rail Travel Pty Ltd is not responsible for any loss, accident, delay or irregularity whatsoever resulting from a third party supplier's acts or omissions. The travel services provided by these suppliers are subject to the conditions imposed by the suppliers and their liability may be limited by their tariffs, conditions of carriage, and agreements. Seasonal conditions occasionally necessitate adjustments to touring.

Holiday Package/Tour Cancellations

Great Southern Rail Travel Pty Ltd reserves the right to amend/ cancel tours at any time.

Departure and Arrival Times

Great Southern Rail Travel Pty Ltd does not guarantee departure or arrival times or the operation of any service. Great Southern Rail Travel Pty Ltd is not liable for any delay, including without limitation any failure to meet connections with other services.

Train Travel

Timetables are subject to change without notice. Call 13 21 47 for current timetable information.

Travel Insurance

Travel insurance is strongly suggested to protect your holiday plans. For additional information and/or a Product Disclosure Statement please contact Great Southern Rail on 13 21 47.

If your car is being conveyed on our Motorail Service, it is suggested that you have transit insurance.

Non Smoking Policy

All Great Southern Rail services are entirely smoke free in accordance with relevant state government regulations. You agree to comply with Great Southern Rail's strict No Smoking Policy.

Luggage: Train Travel

50 kilograms of luggage per person for Gold Service may be conveyed free of charge in the luggage car. This allows 2 items not exceeding 25kg each and not exceeding 180 linear centimetres. 75 kilograms (3 items not exceeding 25kg each) of luggage per person for Platinum Service. 40 kilograms (2 items not exceeding 20kg each) of luggage per person for Red Service. Excess luggage prices on application. Due to space constraints, guests should only take onboard hand luggage required for their journey. Luggage check in opens 2 hours prior to departure and will close 60 minutes prior to departure. Unchecked luggage is carried at owner's risk. Cardboard, plastic or wooden boxes, garbage bags or tea chests will not be accepted as baggage. For a list of acceptable luggage and non-luggage items, visit www.greatsouthernrail.com.au

Bags should be secured and carry the owner's name, destination and contact phone number both inside and outside the bag. Explosive, combustible and inflammable materials are prohibited. Items such as foodstuffs, plants, animals and furniture cannot be accepted as personal luggage.

You may take the following luggage onboard:

Platinum Service – Twin Berth and Double Berth Sleeper Cabins:

May take one small suitcase not exceeding 10 kilograms per person plus hand luggage including garment bag, cabin bag, briefcase.

Gold Service – Twin Berth Sleeper Cabin:

May take one small suitcase not exceeding 10 kilograms per person plus hand luggage including garment bag, cabin bag, briefcase.

Gold Service – Single Berth Sleeper Cabin:

May take hand luggage including garment bag, cabin bag, briefcase.

Red Service – Day/Nighter Seat:

May take cabin bag.

Due to cabin space constraints, it is recommended Gold and Red Service guests take an 'overnight bag' containing the requirements for their journey with them and check in all their luggage. Please note, checked in luggage cannot be accessed during the journey.

Luggage: Hotel, Touring, Coach and Air Travel

Guests must abide by the following luggage limitations depending on the transport options to be utilised in their holiday packages:

Coach and Air Travel: Each guest is entitled to take one case. The sum of the case's length, width and depth must not exceed 140cm (54 inches), and a weight limit of 23 kilograms applies subject to the individual transport operator. Personal items such as tissues, cameras, make-up, etc., should be carried in a travel bag. Over limit luggage cannot be carried. Baggage is entirely at "owner's risk" and Great Southern Rail Travel Pty Ltd strongly suggests that you obtain travel insurance to cover any loss or damage to baggage. Airlines permit only one cabin bag per person to be carried on aircraft.



To book your train holiday
call Great Southern Rail.

13 21 47

www.greatsouthernrail.com.au

Your Travel Agent:



facebook.com/GreatSouthernRail

Great Southern Rail Travel Pty Ltd

PO Box 445, Marleston Business Centre Marleston, SA 5033

Email: salesenquiries@gsr.com.au **Facsimile:** (08) 8213 4576

Travel Agent Licence Number: TTA 164 190

ABN: 84 088 933 742 **ACN:** 088 933 742

03078CDGM 1013